

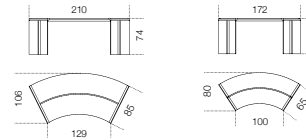

President Junior/President Senior

Studio G&R, 1971

Desk in transparent tempered glass. Bright stainless steel metal parts. Satin stainless steel, bright or satin brass or embossed white or black lacquered metal parts, on request. For a proper cable management, a hole on the top can be arranged upon request. Minimum distance from the edge: 10cm.



Size

President Junior
67 $\frac{3}{4}$ " x 31 $\frac{1}{2}$ " x 29 $\frac{1}{4}$ "h (172 x 80 x 74h cm)

President senior
82 $\frac{3}{4}$ " x 41 $\frac{3}{4}$ " x 29 $\frac{1}{4}$ "h (210 x 106 x 74h cm)

