



# Ambrosia

## Ciszak Dalmas

marset



**Ambrosia A 60 left**

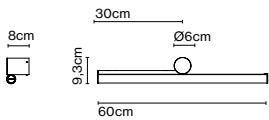

**Ambrosia A 60 right**

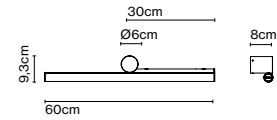

**Disk accessory**

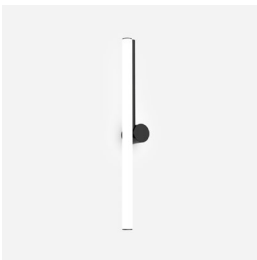

info@marset.com  
www.marset.com

**Ambrosia A 90 left**

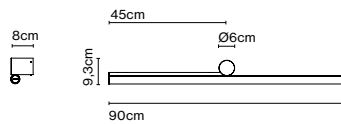

**Ambrosia A 90 right**

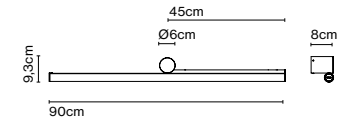

**Ambrosia A 210**

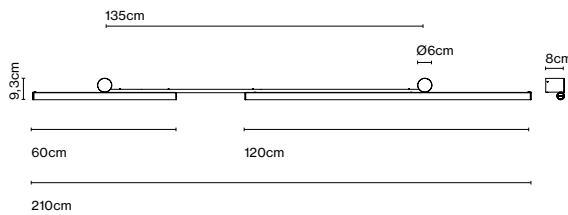

**Power supply (RSC)**

- Power supply 20W - 24V - Clase II - Triac
- Power supply 50W - 24V - Clase II - Triac
- Power supply 35W - 24V - Clase II - DALI
- Power supply 60W - 24V - Clase II - DALI

**Aluminium structure. Methacrylate light tube.**

- Black
- Matt Gold

**Ambrosia A 60**

- Light source Ambrosia 22K: LED SMD 24Vdc 9,6W 2200K CRI80 1058lm
- Light source Ambrosia 27K: LED SMD 24Vdc 9,6W 2700K CRI90 1014lm
- Light source Ambrosia 30K: LED SMD 24Vdc 9,6W 3000K CRI90 1028lm

Luminaire Ambrosia A 60:  
(Power supply not included)

**Ambrosia A 90**

- Light source Ambrosia 22K: LED SMD 24Vdc 14,4W 2200K CRI80 1587lm
- Light source Ambrosia 27K: LED SMD 24Vdc 14,4W 2700K CRI90 1521lm
- Light source Ambrosia 30K: LED SMD 24Vdc 14,4W 3000K CRI90 1692lm

Luminaire Ambrosia A 90:  
(Power supply not included)

**Ambrosia A 210**

- Light source Ambrosia 22K: LED SMD 24Vdc 28,8W 2200K CRI80 3174lm
- Luminaire Ambrosia 22K: (Power supply not included) 2802lm

- Light source Ambrosia 27K: LED SMD 24Vdc 28,8W 2700K CRI90 3042lm
- Luminaire Ambrosia 27K: (Power supply not included) 2812lm

- Light source Ambrosia 30K: LED SMD 24Vdc 28,8W 3000K CRI90 3384lm
- Luminaire Ambrosia 30K: (Power supply not included) 2865lm



\*It depends on the purchased power supply, Triac o DALI. 24V remote power supply to be ordered separately.

The starting point for the Ambrosia was to bring back the traditional Linestra lamp to update it and show that a technical, resolute design can also be poetic.



**Ambrosia A 60 AC left**

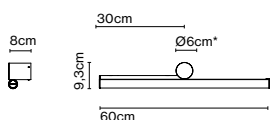

\*7,2cm DALI

**Ambrosia A 60 AC right**

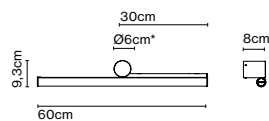

\*7,2cm DALI

**Ambrosia A 90 AC left**

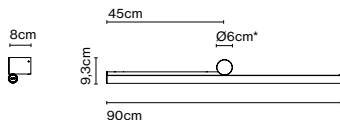

\*7,2cm DALI

**Ambrosia A 90 AC right**

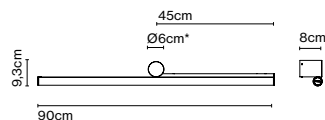

\*7,2cm DALI

**Ambrosia A 60 AC**

Luminaire 22K:  
220-240VAC 2200K CRI90  
TRIAC 10,7W 1112lm  
DALI 11,1W 1112lm

Luminaire 27K  
220-240VAC 2700K CRI90  
TRIAC 10,7W 1171lm  
DALI 11,1W 1171lm

Luminaire 30K  
220-240VAC 3000K CRI90  
TRIAC 10,7W 1089lm  
DALI 11,1W 1089lm

**Ambrosia A 90 AC**

Luminaire 22K:  
220-240VAC 2200K CRI90  
TRIAC 15,4W 1668lm  
DALI 15,55W 1668lm

Luminaire 27K  
220-240VAC 2700K CRI90  
TRIAC 15,4W 1756lm  
DALI 15,55W 1756lm

Luminaire 30K  
220-240VAC 3000K CRI90  
TRIAC 15,4W 1634lm  
DALI 15,55W 1634lm

Aluminium structure. Methacrylate light tube.

- Black
- Matt Gold

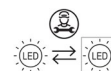
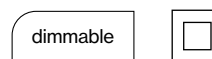

- [Download](#) Assembly instructions
- [Download](#) Photometric data
- [Download](#) 2D
- [Download](#) 3D

The starting point for Ambrosia began as a strip light became a modular system that can be extended to fit any space. Its warm, diffuse light fills the space, adding beauty and illuminating any project.