



Description

The first outdoor lighting collection in the Brokis portfolio, Bonbori was created by world-renowned Japanese designer Fumie Shibata, who took inspiration from the traditional paper lamps lining the paths to shrines and temples during the annual rice harvest festival in Japan.



Tech. description

The light comprises a metal body, base bracket, glass shade, and diffuser. All metal components are crafted from stainless steel. The light is IP44 compliant and is connected directly to inground wiring.

Colours options: https://brokis.sharepoint.com/:b:/s/brokis_sp/EWFII6xseeFGk3tXqV61MMwB8v3hFAL0PHo5ah3jZUIMNA

CONSTRUCTION SPECIFICATION

Weight:	6 kg
Construction material:	glass, stainless steel
Cord length [mm]:	-
Mounting:	Floor
Environment:	Outdoor

DIMENSIONS [mm]

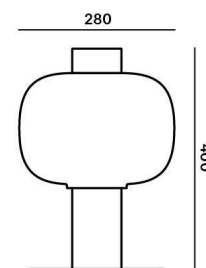

ELECTRICAL SPECIFICATION

Input voltage [V]:	230 V
Frequency [Hz]:	50-60 Hz
Max. power [W]:	60 W
Coverage IP:	44
Socket:	E27
Light source:	-
Energy class:	A+ to E depending on light source

CERTIFICATIONS



DATASHEET

RECOMMENDED BULBS



Download



CM8790

Socket	E27
Type	LED filament
Lamp wattage [W]	12 W
Input voltage [V]	220 - 240 VAC
Energy class	A+
Flux [lm]	1050 lm
Light colour [K]	2600 K
CRI	85+
Lifespan [h]	20000h
Dimmable	yes
Dimensions h x w [mm]	175 x 32 mm



BROKIS®

BROKIS S.R.O.
ŠPANIĚLOVA 1315/25
163 00 PRAHA 6 - ŘEPY
CZECH REPUBLIC

ORG ID 64940799
VAT ID CZ64940799
C 42174 MĚSTSKÝ SOUD
V PRAZE

TEL +420 567 211 517
TECHNICAL@BROKIS.CZ
INFO@BROKIS.CZ
WWW.BROKIS.CZ

2020_08
PAGE 2

DATASHEET

RECOMENDED CANOPY



Download

CEILING CANOPY

Dimensions O x w [mm]	80x128 mm
Weight [kg]	0,3 kg
Material	stainless steel

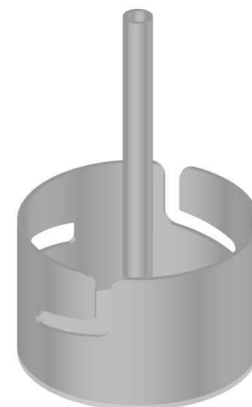

Drawing

Canopy bracket

