

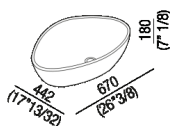

Over countertop washbasin with waste
ACER1098L_

Benedini Associati, 2014

Over countertop washbasin in Cristalplant®
biobased or marble.



Shaped over countertop washbasin in white Cristalplant® biobased or in white Carrara marble, grey carnic marble or black Marquina marble, green Alpi marble or Emperador dark marble; without tap hole and overflow. Waste included with cap flush with the washbasin's inner surface, in the same finish like the washbasin.

Finishes



White



White Carrara



Grey Carnico



Black Marquina



Green Alpi



Dark Emperador

Materials



Cristalplant® biobased



Marble

Height:	18 cm	7" 1/8 inches
Width:	67 cm	26" 3/8 inches
Weight:	12 kg	26 lbs
Depth:	44.2 cm	17" 13/32 inches
Packaging:	73 x 50 x 30 cm	28" 47/64 x 9" 11/16 x 11" 13/16 inches
Total weight:	14 kg	31 lbs

Note: The washbasin is also available in stone or marble types on demand. Price to be calculated.

The above measurements refer to the Cristalplant® biobased version, for the marble version the measurements are: Weight: 35 lbsPackaging: 28" 47/64 x 9" 11/16 x 11" 13/16Gross weight: 35 lbs



Tap position, recommended height

POSIZIONE RUBINETTERIA / TAP POSITION

Altezza consigliata / Recommended height

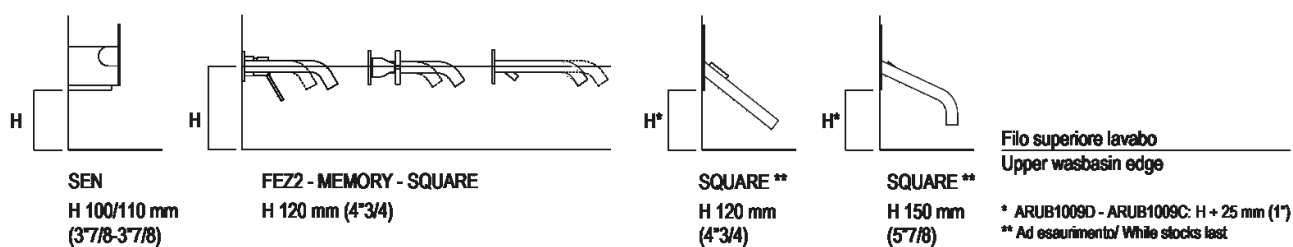



Main dimensions

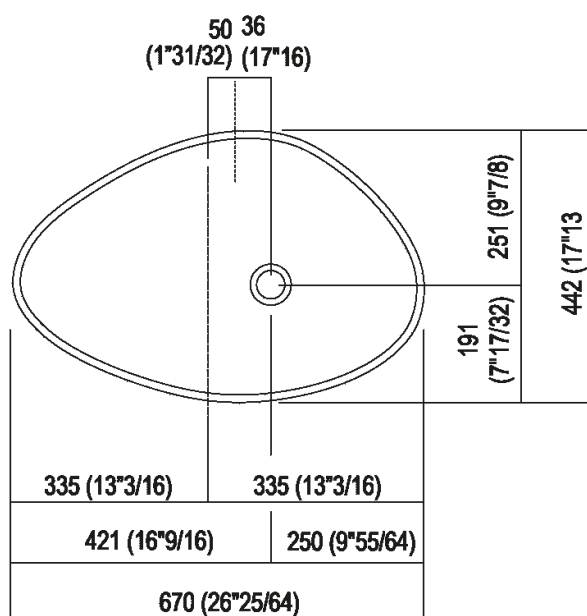
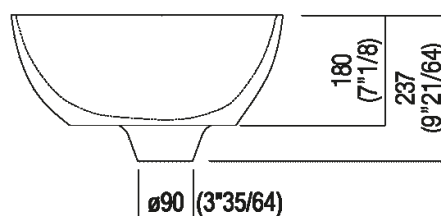
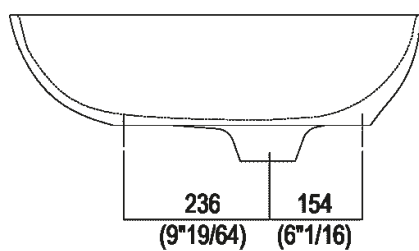



Installation notes: on self-bearing countertop

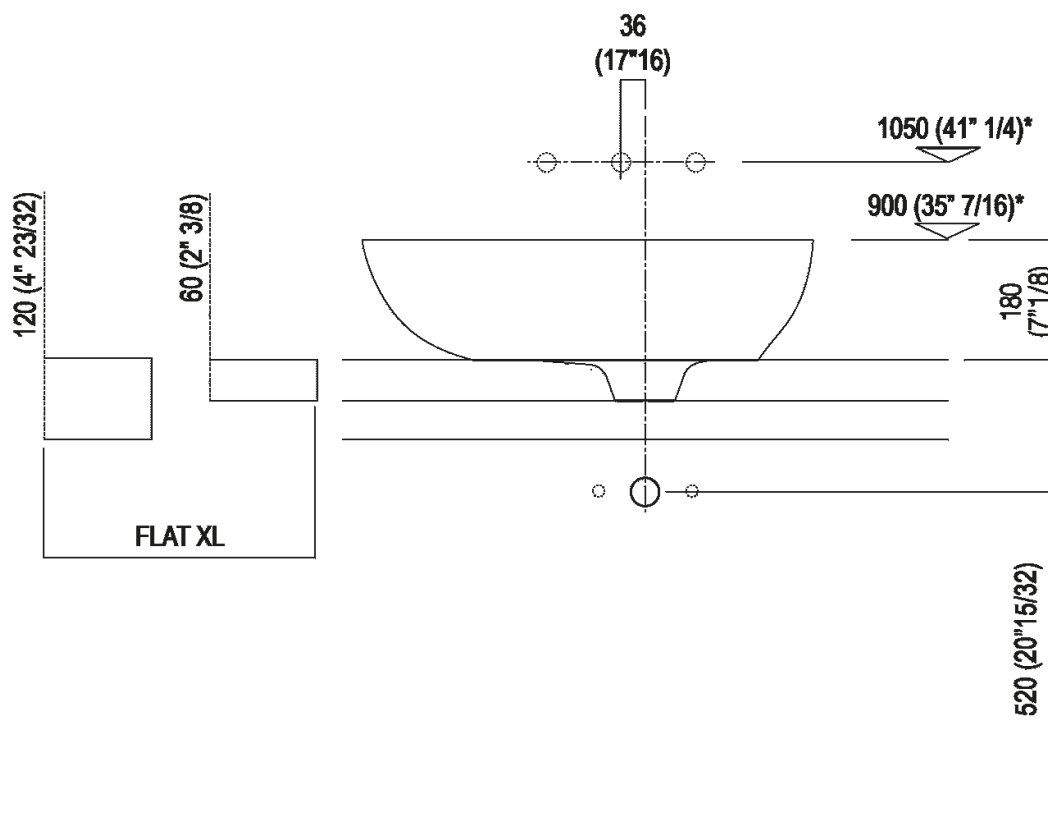

Scarico per sifone a bottiglia
Drain for bottle trap

*h.consigliata / advised h.



Installation notes: on self-bearing countertop

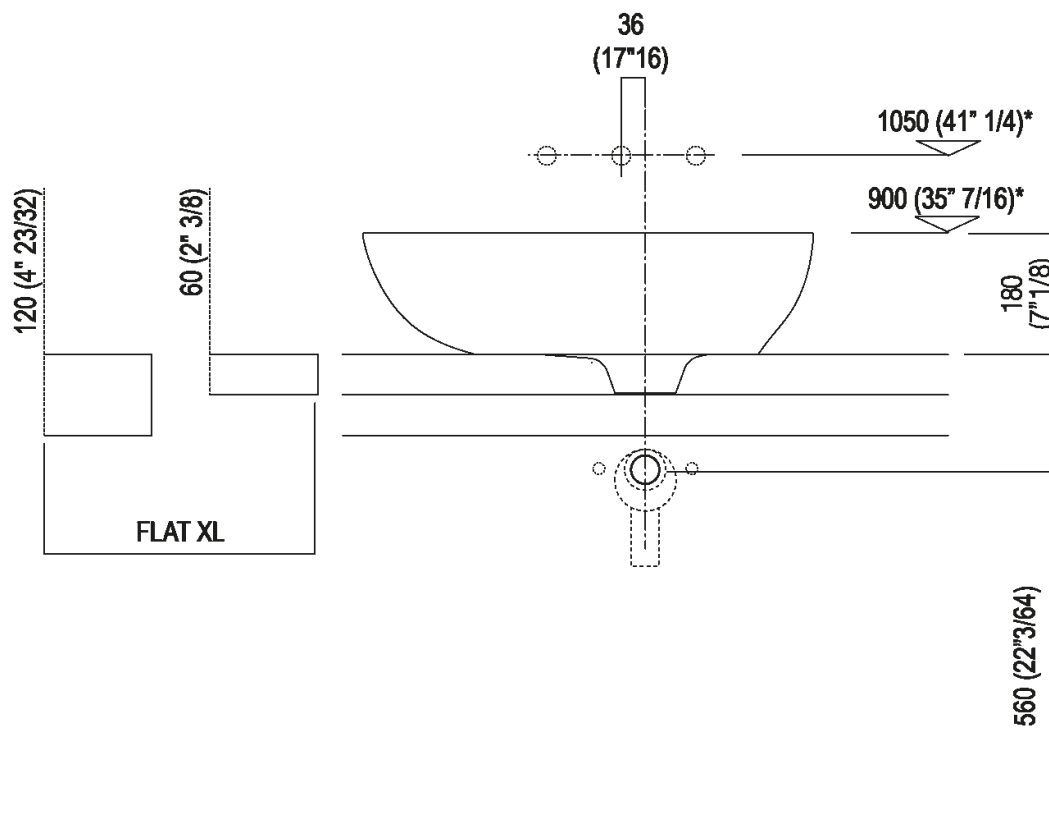

Scarico per sifone ad incasso
 Drain for concealed waste trap

*h.consigliata / advised h.



Installation notes: on countertop to be resede on cabinets

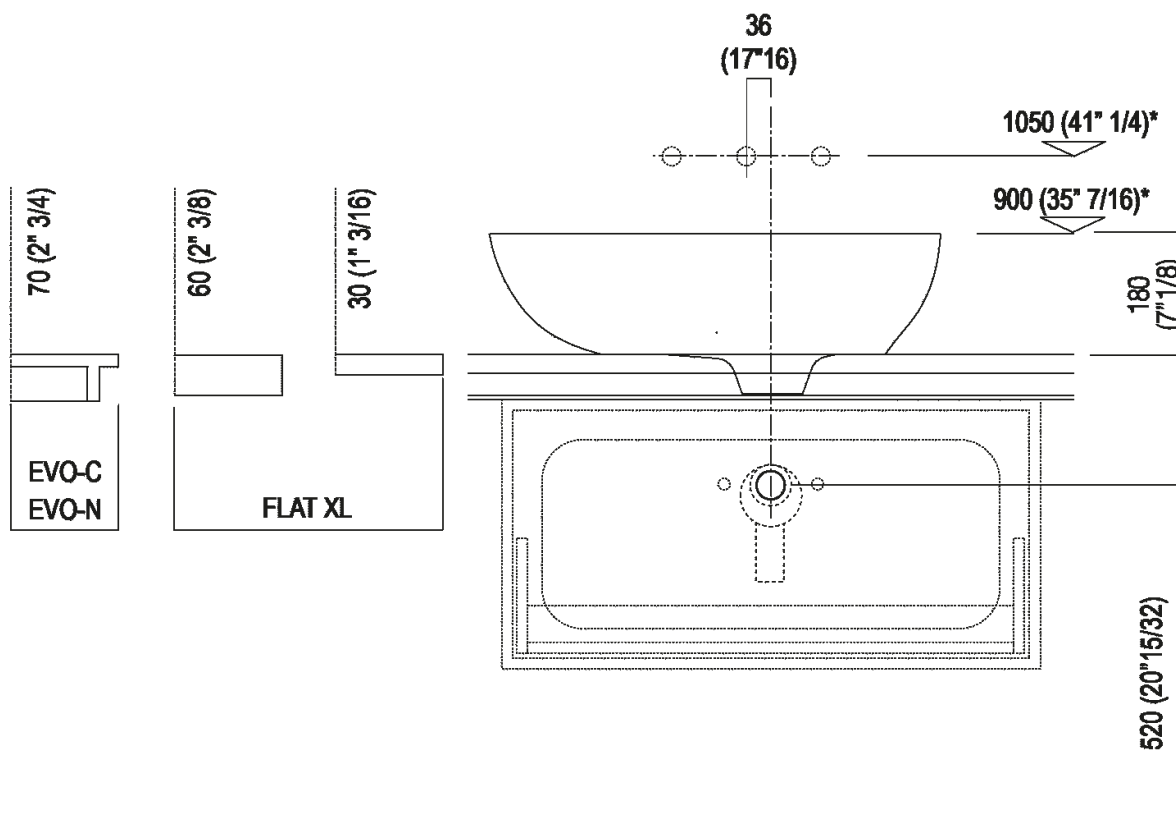

Scarico per sifone a bottiglia e ad incasso
Drain for bottle trap and concealed waste trap

*h.consigliata / advised h.



Installation notes: on casing H 40 cm Lato

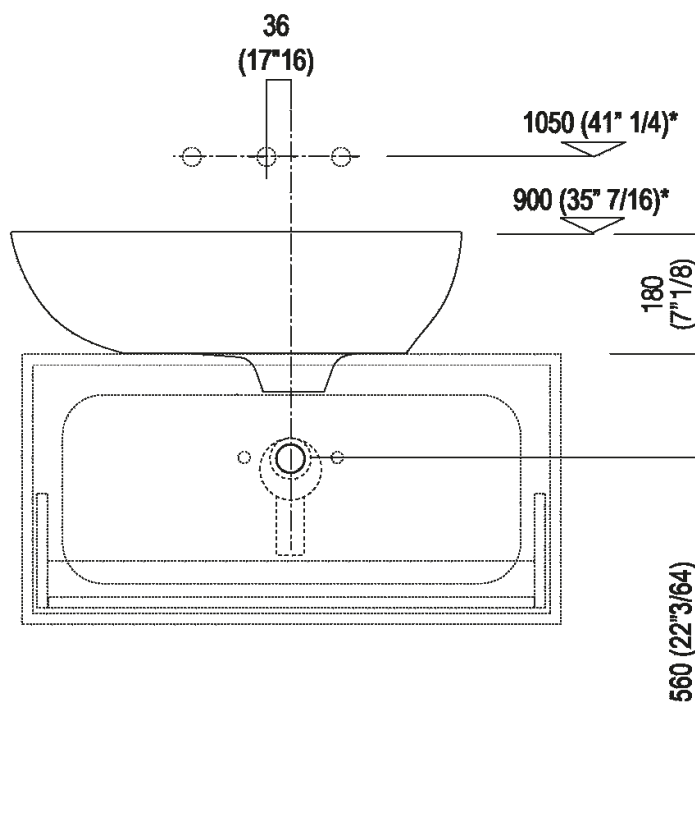

Scarico per sifone a bottiglia o ad incasso
Drain for bottle trap or concealed waste trap

***h.consigliata / advised h.**



Installation notes: on casing H 20 cm Lato

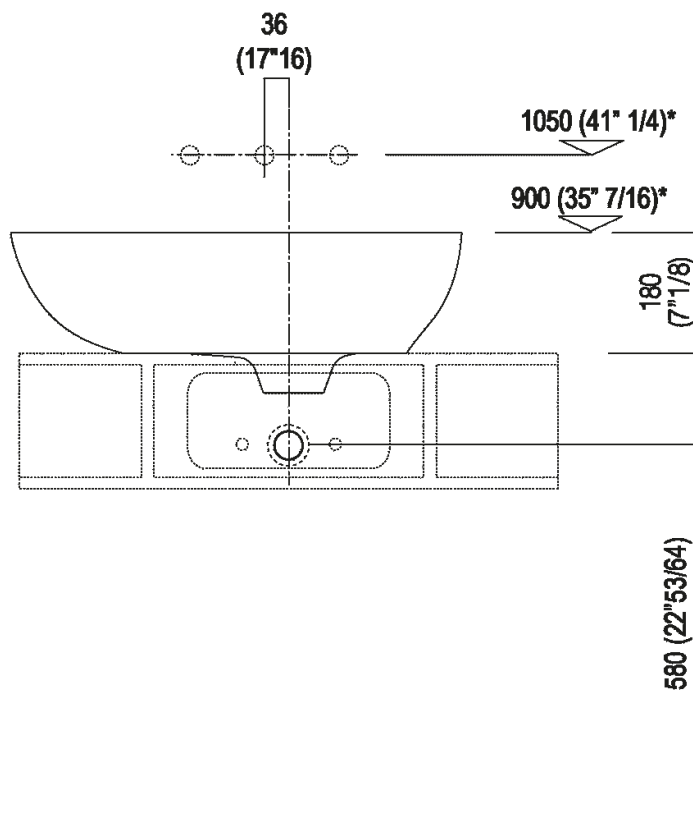

Scarico per sifone a bottiglia
Drain for bottle trap

***h.consigliata / advised h.**



Holes for countertop washbasins and top mounted taps for top

PIANO cm 50 / COUNTERTOP cm 50

Posizione standard per rubinetto su piano
Standard position for top mounted tap

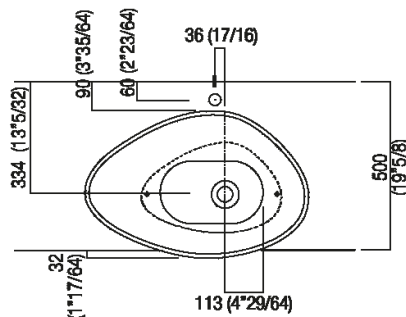

Posizione standard per rubinetto a parete
Standard position for wall mounted tap

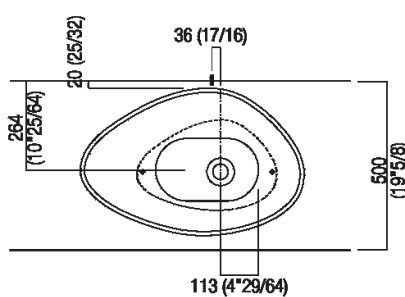

Posizione speciale per rubinetto Sen a
parete e Square con bocca curva
Special position for wall mounted tap
Sen and Square white curved spout

NON NECESSARIA
NOT NECESSARY