



DESCRIPTION

Typology

Table

Legs

Aluminium lacquer - painted brushed casting

Top

Honeycomb panel with frame in solid wood lacquered - painted brushed

Insert

Medium-density fibre panel in veneer - marble

DIMENSIONS

Rectangular

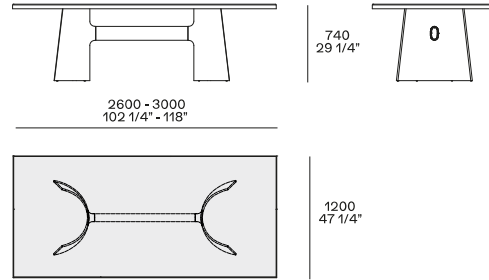
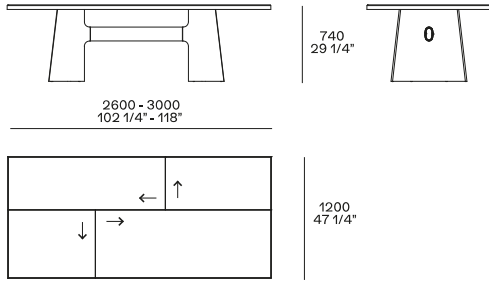

The drawings show the direction of the wooden grain

Round

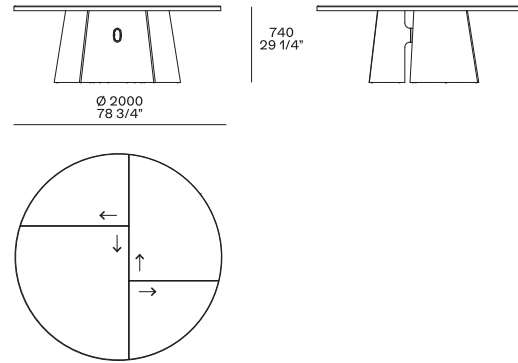
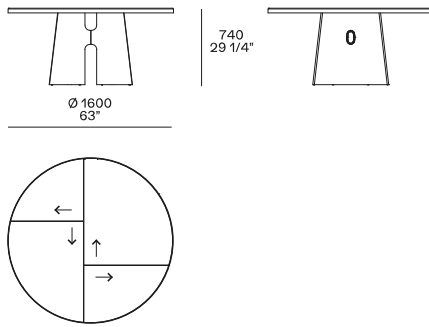

The drawings show the direction of the wooden grain

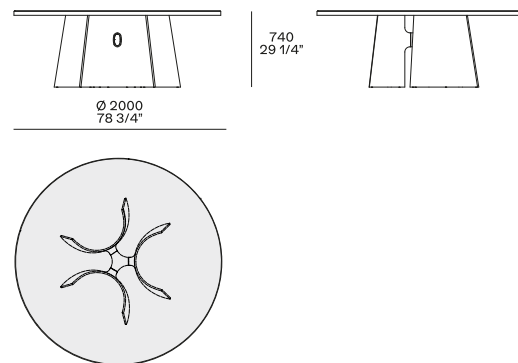
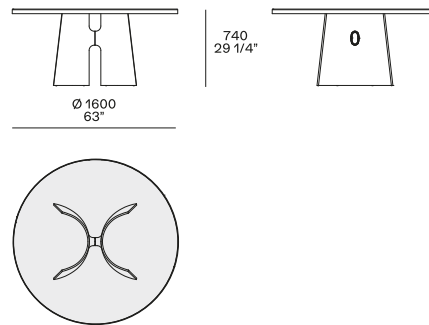

STRUCTURE FINISHES

Metal parts



Metal parts

TOP FINISHES

Wood



Woods

Marble

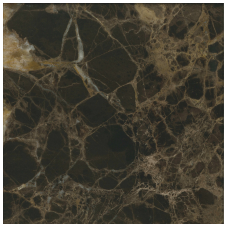

Mat marble



Glossy marble

Glass



Glass