

# Planet Post

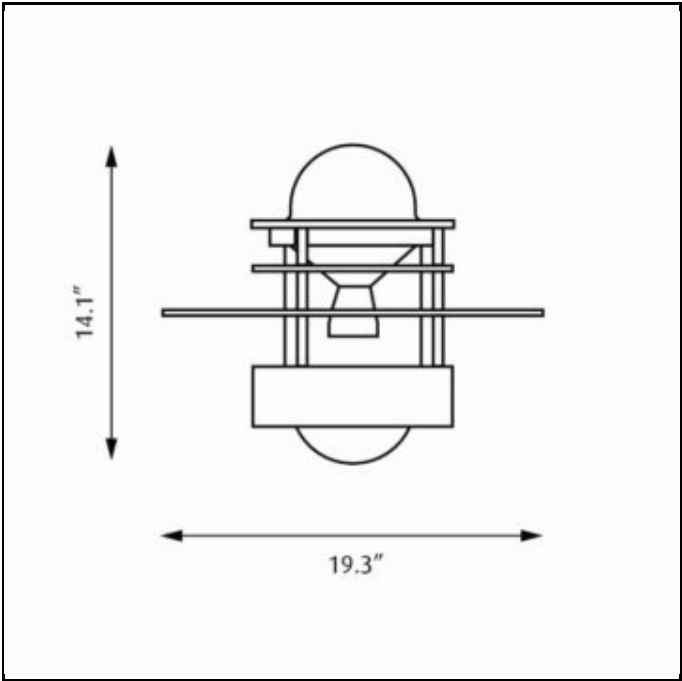

- Design

Jens Møller-Jensen
- Concept

The fixture emits symmetrical light directed primarily downwards due to two reflector rings. However, the rings also permit some light to pass upwards, illuminating the fixture. The anti-glare ring prevents from horizontal glare. The diffuser is available either as clear, opal or partly frosted depending on the desired light source to prevent from vertical glare.
- Finish

Natural painted aluminum or white, powder coated.
- Material

Diffuser: Injection molded clear polycarbonate(INC), injection molded partly frosted polycarbonate (CMH) or injection molded white opal polycarbonate(CF). Saturn ring: Die cut aluminum. Anti-glare ring: Spun aluminum. Top: Die cast aluminum.
- Mounting

Post top: Mounted on triangular (TRI), davit (DAV), or straight (SRA) arm.
- Weight

Max. 15 lbs.
- Label

cULus, Wet location. IBEW.

Product Code	Light source	Voltage	Finish	Transition to pole
PLA-PT	1/100W/MH/ED-17 medium	120/277V	NAT PAINT ALU	SRA/TRI/DAV
	1/26W/32W/42W/CF GX24q-3/4	120-277V	WHT	
	1/70W/CMH/T-6 G12			

**Specification notes**  
a. CMH and MH variant provided with 120/277V ballast.  
b. CF variant provided with 120-277V ballast.

# Planet Post

PLA-PT-MH

PRODUCT SPECIFICATION

## Product description

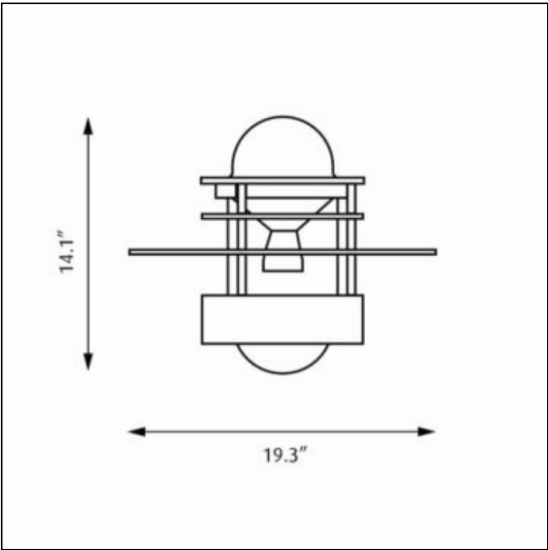

Design Jens Møller-Jensen

Concept The fixture emits symmetrical light directed primarily downwards due to two reflector rings. However, the rings also permit some light to pass upwards, illuminating the fixture. The anti-glare ring prevents from horizontal glare. The diffuser is available either as clear, opal or partly frosted depending on the desired light source to prevent from vertical glare.

Finish Natural painted aluminum or white, powder coated.

Material Diffuser: Injection molded clear polycarbonate(INC), injection molded partly frosted polycarbonate (CMH) or injection molded white opal polycarbonate(CF). Saturn ring: Die cut aluminum. Anti-glare ring: Spun aluminum. Top: Die cast aluminum.

Mounting Post top: Mounted on triangular (TRI), davit (DAV), or straight (SRA) arm.

Weight Max. 15 lbs.

Label cULus, Wet location. IBEW.

Product Code	Light source	Voltage	Finish	Transition to pole
PLA-PT	1/100W/MH/ED-17 medium	120/277V	NAT PAINT ALU	SRA/TRI/DAV
	1/26W/32W/42W/CF GX24q-3/4	120-277V	WHT	
	1/70W/CMH/T-6 G12			

### Specification notes

- a. CMH and MH variant provided with 120/277V ballast.
- b. CF variant provided with 120-277V ballast.

# Planet Post

PLA-PT-MH

PRODUCT SPECIFICATION

## Material description

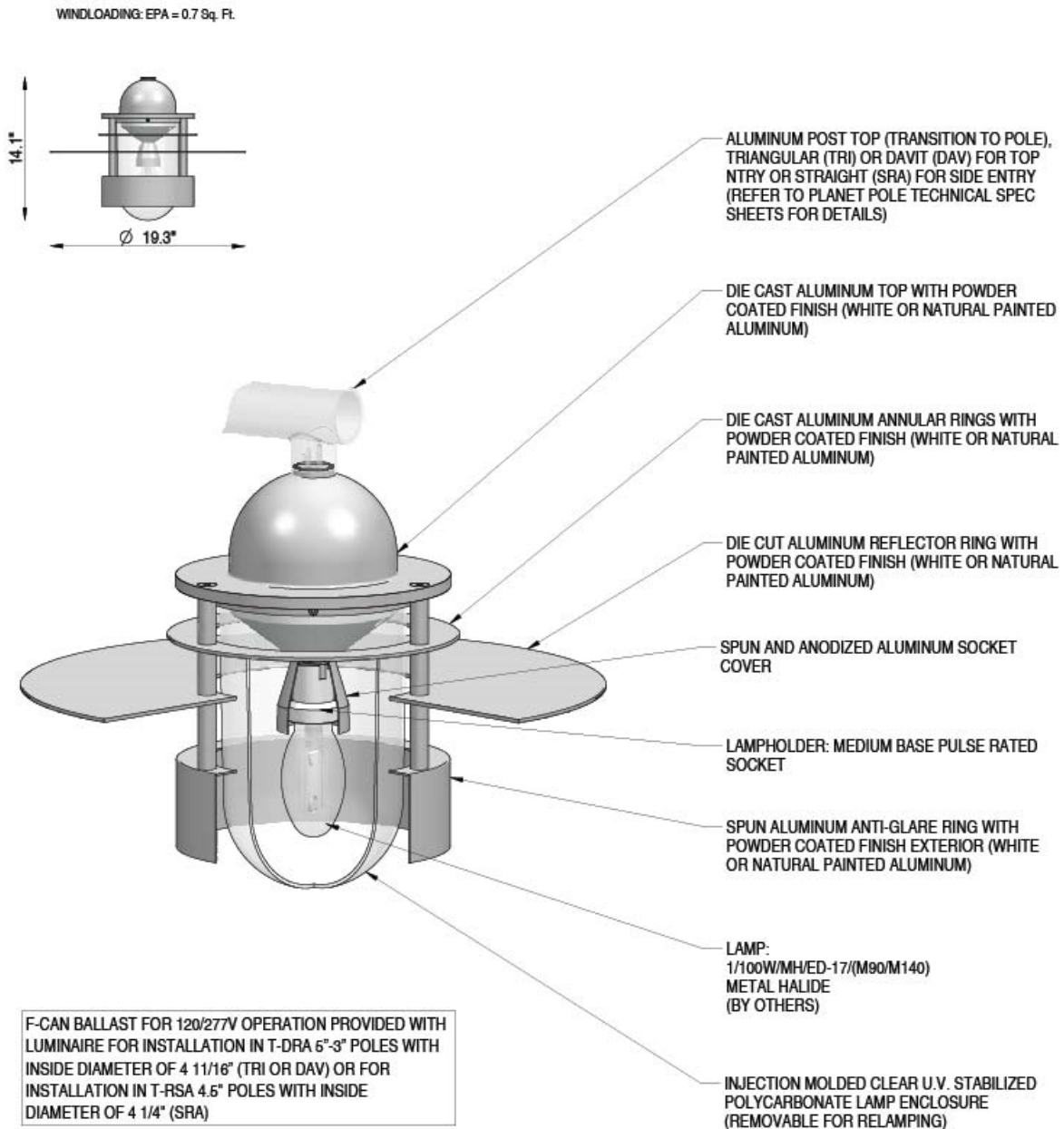

Light Measurements

Photometric Report: PLA-PT-1-100W-MH-WHITE  
Report No.: LP1074  
Poulsen Report No.: PLA-PT-1-100W-MH-WHITE  
Luminaire: PLANET POST  
Lamp: 1/100W/MH/ED-17  
Efficiency: 77%  
Description: All data shown are per 8800 lumens. This report can be used for calculation on all versions listed below. Use only actual lumen data calculating.

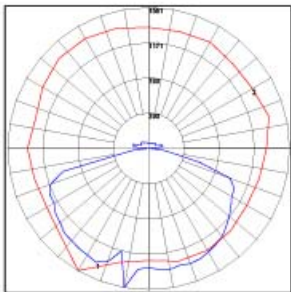

Candlepower Distribution	
Vertical Angle	Candela
0	1315.6
5	1256.4
15	1360.7
25	1388.8
35	1341.0
45	1267.7
55	1228.3
65	1129.7
75	774.7
90	0.0
120	95.7
150	67.6
180	58.1

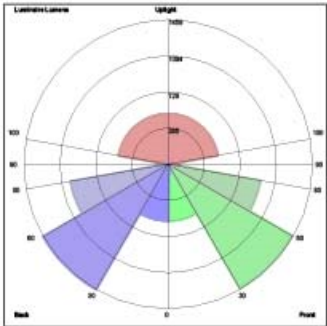

LUMINAIRE CLASSIFICATION SYSTEM (LCS)

	Lumens	% Lamp	% Luminaire
FL - Front-Low (0-30)	570.6	6.5	8.4
FM - Front-Medium (30-60)	1446.0	16.4	21.4
FH - Front-High (60-90)	945.6	10.7	14.0
FVH - Front-Very High (90-180)	68.7	0.8	1.0
BL - Back-Low (0-30)	568.9	6.5	8.4
BM - Back-Medium (30-60)	1458.9	16.6	21.6
BH - Back-High (60-90)	1000.9	11.4	14.8
BVH - Back-Very High (90-180)	82.1	0.9	1.2
UL - Uplight-Low (0-100)	108.6	1.2	1.6
UH - Uplight-High (100-180)	506.6	5.8	7.5
Total	6757.9	76.8	100.0
BUG Rating	B3-U4-G1		

Zonal Lumen Summary			
Zone	Lumens	% Lamp	% Fixture
0-20	510.59	5.80	7.60
0-30	1139.58	12.90	16.90
0-40	1975.07	22.40	29.20
0-60	4044.49	46.00	59.80
0-80	5990.96	68.10	88.70
0-90	6142.74	69.80	90.90
10-90	6014.62	68.30	89.00
20-40	1464.48	16.60	21.70
20-50	2453.18	27.90	36.30
40-70	3203.83	36.40	47.40
60-80	1946.47	22.10	28.80
70-80	812.05	9.20	12.00
80-90	151.78	1.70	2.20
90-110	264.52	3.00	3.90
90-120	353.79	4.00	5.20
90-130	438.98	5.00	6.50
90-150	559.29	6.40	8.30
90-180	615.15	7.00	9.10
110-180	350.62	4.00	5.20
0-180	6757.88	76.80	100.00

# Planet Post

PLA-PT-CMH

PRODUCT SPECIFICATION

## Product description

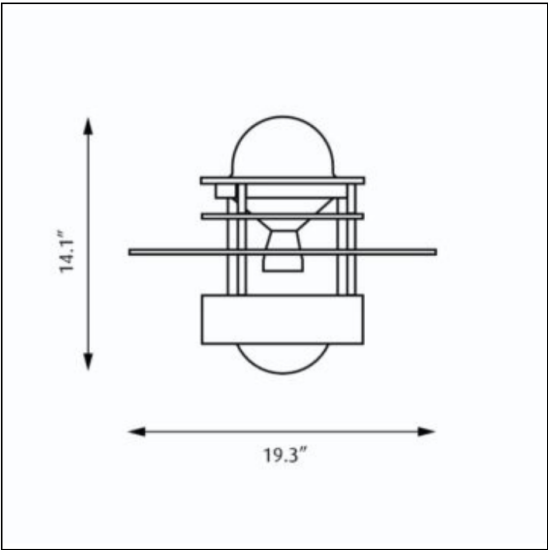

Design Jens Møller-Jensen

**Concept** The fixture emits symmetrical light directed primarily downwards due to two reflector rings. However, the rings also permit some light to pass upwards, illuminating the fixture. The anti-glare ring prevents from horizontal glare. The diffuser is available either as clear, opal or partly frosted depending on the desired light source to prevent from vertical glare.

**Finish** Natural painted aluminum or white, powder coated.

**Material** Diffuser: Injection molded clear polycarbonate(INC), injection molded partly frosted polycarbonate (CMH) or injection molded white opal polycarbonate(CF). Saturn ring: Die cut aluminum. Anti-glare ring: Spun aluminum. Top: Die cast aluminum.

**Mounting** Post top: Mounted on triangular (TRI), davit (DAV), or straight (SRA) arm.

**Weight** Max. 15 lbs.

**Label** cULus, Wet location. IBEW.

Product Code	Light source	Voltage	Finish	Transition to pole
PLA-PT	1/100W/MH/ED-17 medium	120/277V	NAT PAINT ALU	SRA/TRI/DAV
	1/26W/32W/42W/CF GX24q-3/4	120-277V	WHT	
	1/70W/CMH/T-6 G12			

**Specification notes**

- a. CMH and MH variant provided with 120/277V ballast.
- b. CF variant provided with 120-277V ballast.

# Planet Post

PLA-PT-CMH

PRODUCT SPECIFICATION

## Material description

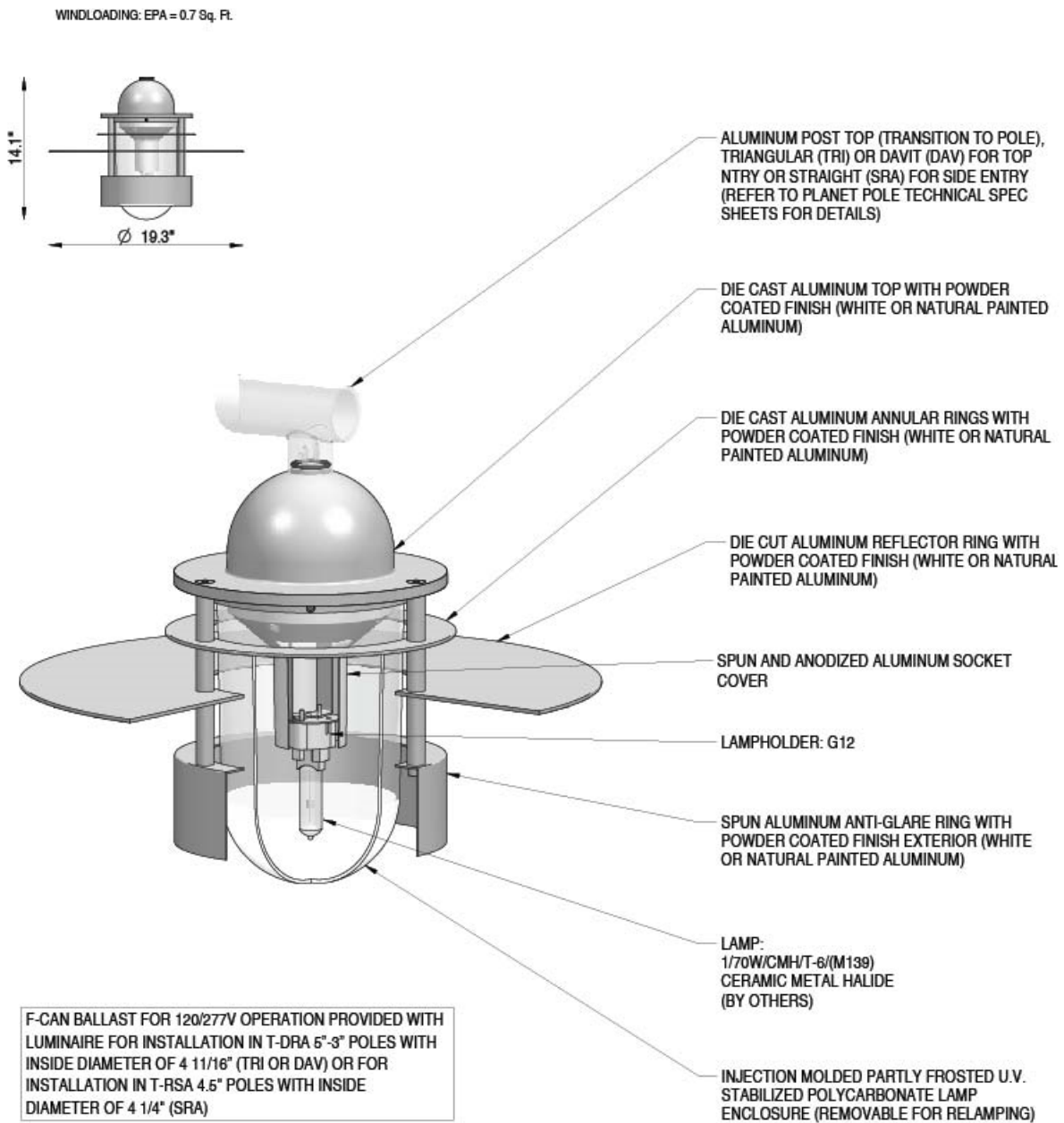

Light Measurements

Photometric Report: PLA-PT-1-70W-CMH-WHITE  
Report No.: 6041902002 Louis Poulsen Lighting A/S  
Poulsen Report No.: PLA-PT-1-70W-CMH-WHITE  
Luminaire: PLANET POST  
Lamp: 1/70W/CMH/T-6 G12  
Efficiency: 75%  
Description: All data shown are per 6600 lumens. This report can be used for calculation on all versions listed below. Use only actual lumen data calculating.

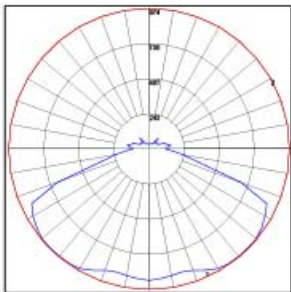

Candlepower Distribution	
Vertical Angle	Candela
0	910.3
5	902.0
15	883.5
25	928.1
35	969.5
45	973.9
55	952.9
65	900.4
75	343.9
90	112.2
120	72.2
150	40.3
180	34.5

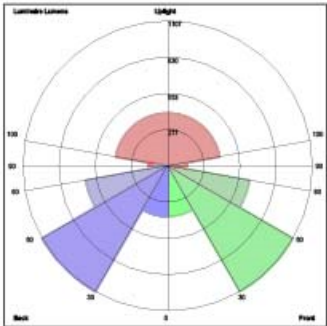

LUMINAIRE CLASSIFICATION SYSTEM (LCS)

	Lumens	% Lamp	% Luminaire
FL - Front-Low (0-30)	383.7	5.8	7.7
FM - Front-Medium (30-60)	1108.6	16.8	22.2
FH - Front-High (60-80)	834.4	9.6	12.7
FVH - Front-Very High (80-90)	93.4	1.4	1.9
BL - Back-Low (0-30)	383.7	5.8	7.7
BM - Back-Medium (30-60)	1108.6	16.8	22.2
BH - Back-High (60-80)	834.4	9.6	12.7
BVH - Back-Very High (80-90)	93.4	1.4	1.9
UL - Uplight-Low (90-100)	144.0	2.2	2.9
UH - Uplight-High (100-180)	400.1	6.1	8.0
Total	4980.3	75.5	100.0
BUG Rating	B2-U3-G1		

Zonal Lumen Summary			
Zone	Lumens	% Lamp	% Fixture
0-20	337.73	5.10	6.80
0-30	767.47	11.60	15.40
0-40	1374.91	20.80	27.60
0-60	2980.76	45.20	59.80
0-80	4249.54	64.40	85.30
0-90	4436.33	67.20	89.10
10-90	4350.47	65.90	87.40
20-40	1037.19	15.70	20.60
20-50	1789.86	27.10	35.90
40-70	2450.89	37.10	49.20
60-80	1268.77	19.20	25.50
70-80	423.74	6.40	8.50
80-90	186.79	2.80	3.80
90-110	281.46	4.30	5.70
90-120	361.00	5.50	7.20
90-130	421.88	6.40	8.50
90-150	511.87	7.80	10.30
90-180	544.07	8.20	10.90
110-180	262.61	4.00	5.30
0-180	4980.4	75.50	100.00

# Planet Post

PLA-PT-CF

PRODUCT SPECIFICATION

## Product description

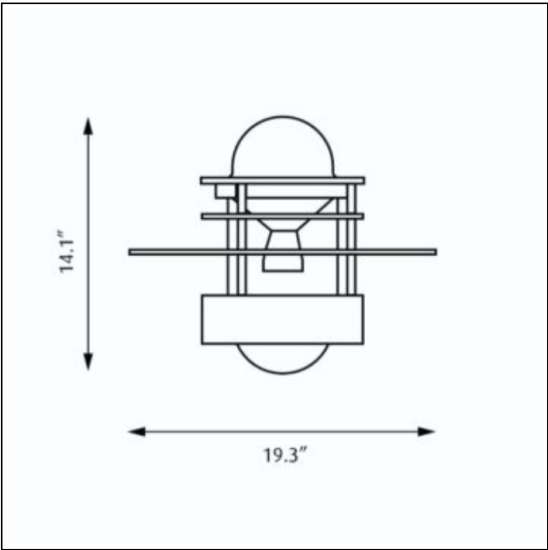

- Design** Jens Møller-Jensen
- Concept** The fixture emits symmetrical light directed primarily downwards due to two reflector rings. However, the rings also permit some light to pass upwards, illuminating the fixture. The anti-glare ring prevents from horizontal glare. The diffuser is available either as clear, opal or partly frosted depending on the desired light source to prevent from vertical glare.
- Finish** Natural painted aluminum or white, powder coated.
- Material** Diffuser: Injection molded clear polycarbonate(INC), injection molded partly frosted polycarbonate (CMH) or injection molded white opal polycarbonate(CF). Saturn ring: Die cut aluminum. Anti-glare ring: Spun aluminum. Top: Die cast aluminum.
- Mounting** Post top: Mounted on triangular (TRI), davit (DAV), or straight (SRA) arm.
- Weight** Max. 15 lbs.
- Label** cULus, Wet location. IBEW.

Product Code	Light source	Voltage	Finish	Transition to pole
PLA-PT	1/100W/MH/ED-17 medium	120/277V	NAT PAINT ALU	SRA/TRI/DAV
	1/26W/32W/42W/CF GX24q-3/4	120-277V	WHT	
	1/70W/CMH/T-6 G12			

**Specification notes**  
a. CMH and MH variant provided with 120/277V ballast.  
b. CF variant provided with 120-277V ballast.



# Planet Post

PLA-PT-CF

PRODUCT SPECIFICATION

## Material description

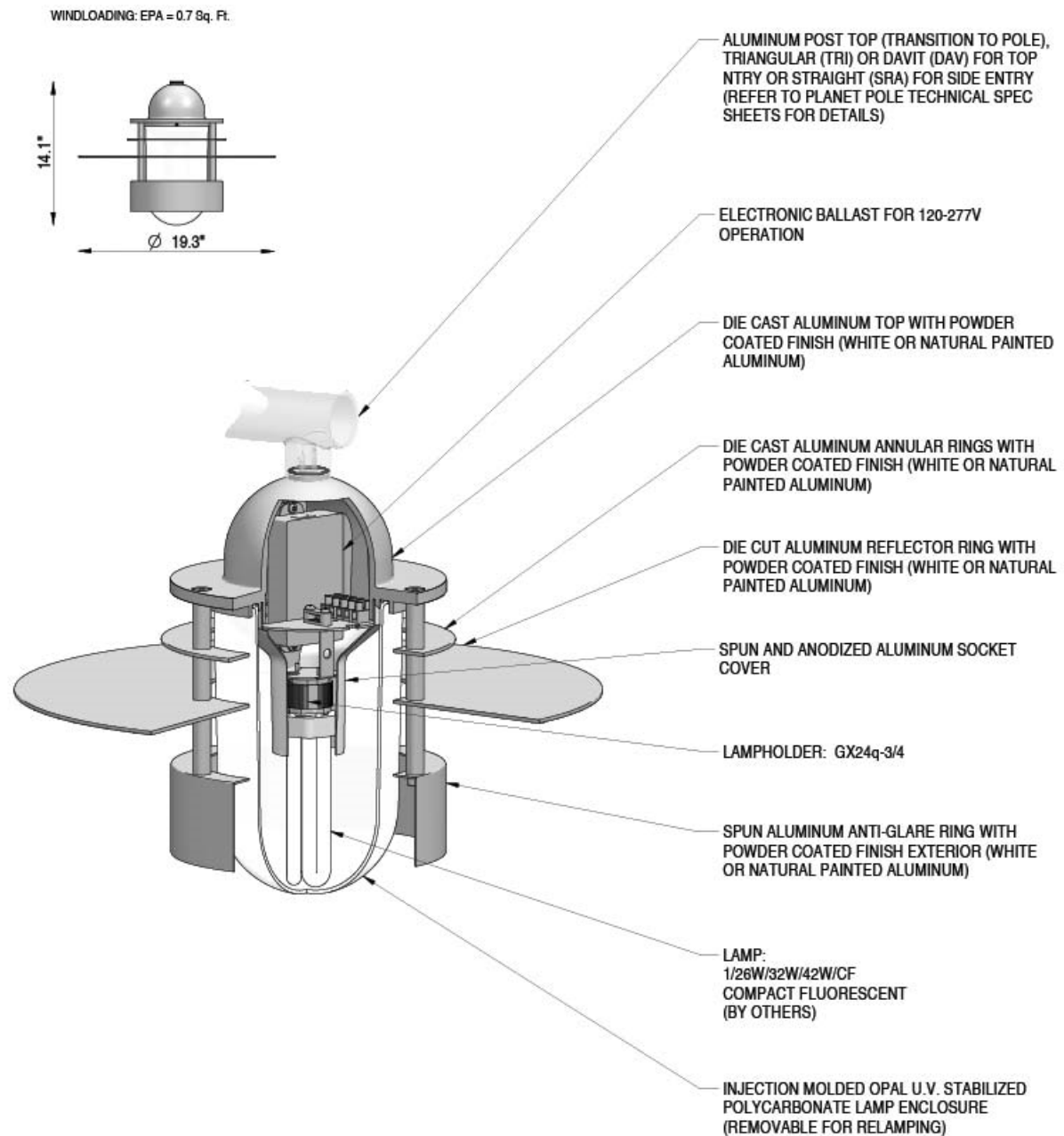

# Planet Post

PLA-PT-CF

PRODUCT SPECIFICATION

## Light Measurements

Photometric Report: PLA-PT-1-42W-CF-WHITE  
Report No.: Louis Poulsen Lighting A/S  
Poulsen Report No.: PLA-PT-1-42W-CF-WHITE  
Luminaire: PLANET POST  
Lamp: 1/42W/CF/GX24q-4  
Efficiency: 51%  
Description: All data shown are per 3200 lumens. This report can be used for calculation on all versions listed below. Use only actual lumen data calculating.

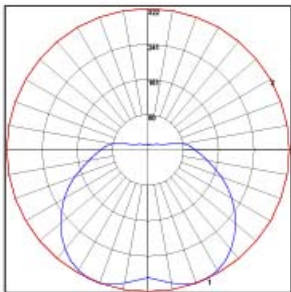

Candlepower Distribution	
Vertical Angle	Candela
0	289.8
5	297.5
15	316.1
25	321.8
35	307.4
45	277.8
55	240.5
65	199.7
75	155.0
90	107.8
120	27.2
150	14.2
180	12.1

Zonal Lumen Summary

Zone	Lumens	% Lamp	% Fixture
0-20	118.23	3.70	7.20
0-30	266.54	8.30	16.30
0-40	458.84	14.30	28.00
0-60	888.87	27.80	54.20
0-80	1251.87	39.10	76.30
0-90	1384.92	43.30	84.50
10-90	1356.24	42.40	82.70
20-40	340.61	10.60	20.80
20-50	555.20	17.40	33.90
40-70	627.61	19.60	38.30
60-80	363.00	11.30	22.10
70-80	165.23	5.20	10.10
80-90	133.04	4.20	8.10
90-110	168.00	5.30	10.20
90-120	198.35	6.20	12.10
90-130	220.20	6.90	13.40
90-150	243.41	7.60	14.80
90-180	254.88	8.00	15.50
110-180	86.88	2.70	5.30
0-180	1639.8	51.20	100.00

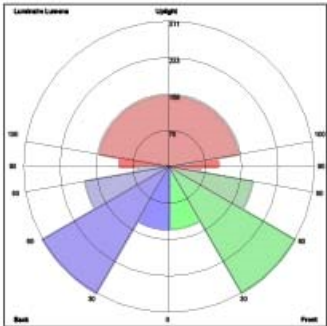

LUMINAIRE CLASSIFICATION SYSTEM (LCS)

	Lumens	% Lamp	% Luminaire
FL - Front-Low (0-30)	133.3	4.2	8.1
FM - Front-Medium (30-60)	311.2	9.7	19.0
FH - Front-High (60-90)	181.5	5.7	11.1
FVH - Front-Very High (90-100)	66.5	2.1	4.1
BL - Back-Low (0-30)	133.3	4.2	8.1
BM - Back-Medium (30-60)	311.2	9.7	19.0
BH - Back-High (60-90)	181.5	5.7	11.1
BVH - Back-Very High (90-100)	66.5	2.1	4.1
UL - Uplight-Low (90-100)	104.9	3.3	6.4
UH - Uplight-High (100-180)	150.0	4.7	9.1
Total	1639.9	51.4	100.0

BUG Rating B1-U3-G1

Design Jens Møller-Jensen

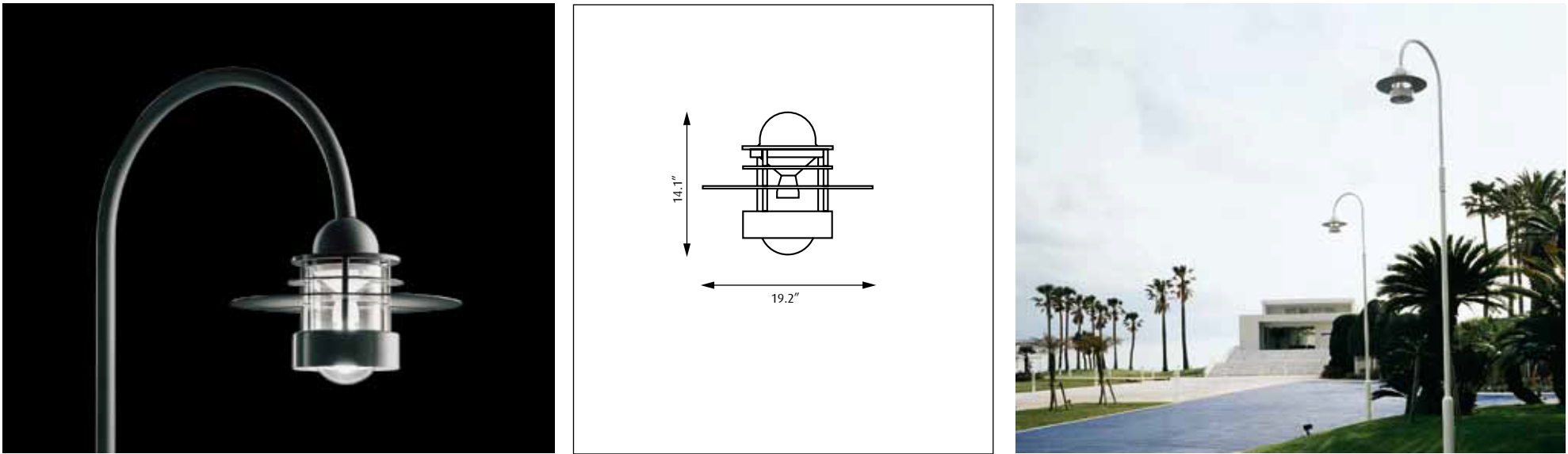

5976741

Light source	Voltage	Weight	Electric shock protection	Ingress protection
1/26W/32W/42W/CF GX24q-3/4 1/70W/CMH/T-6 G12 1/100W/MH/ED-17 Medium	120-277V 120/277V	15 Lbs	Cl. I	IP 44, Wet location

Recommended cleaning substances:

Wipe off dust wiht a dry, soft cloth. Remove greasy spots etc. with a soft cloth dampe-  
ned in lukewarm water (<122° F/ 50° C) with a mild detergent.

Warning: Scouring powder and similar substances will scratch surfaces.

All installation is subject to local code and jurisdiction.

Consult a qualified electrician to ensure correct branch circuit conductor.

The installer must ensure that the foundation is stable and can support the luminiare’s  
weight.

The Installer must use proper means to secure the luminiare to the ground.

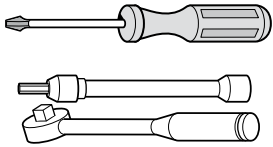
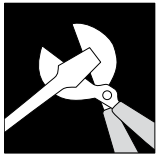

50 lb/in

59767-11

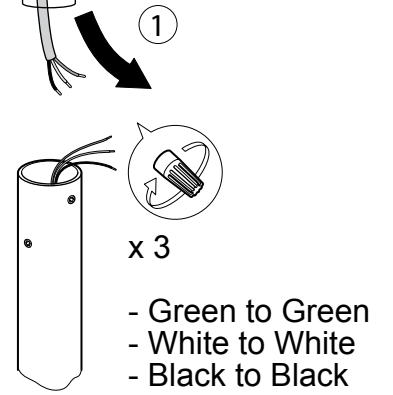
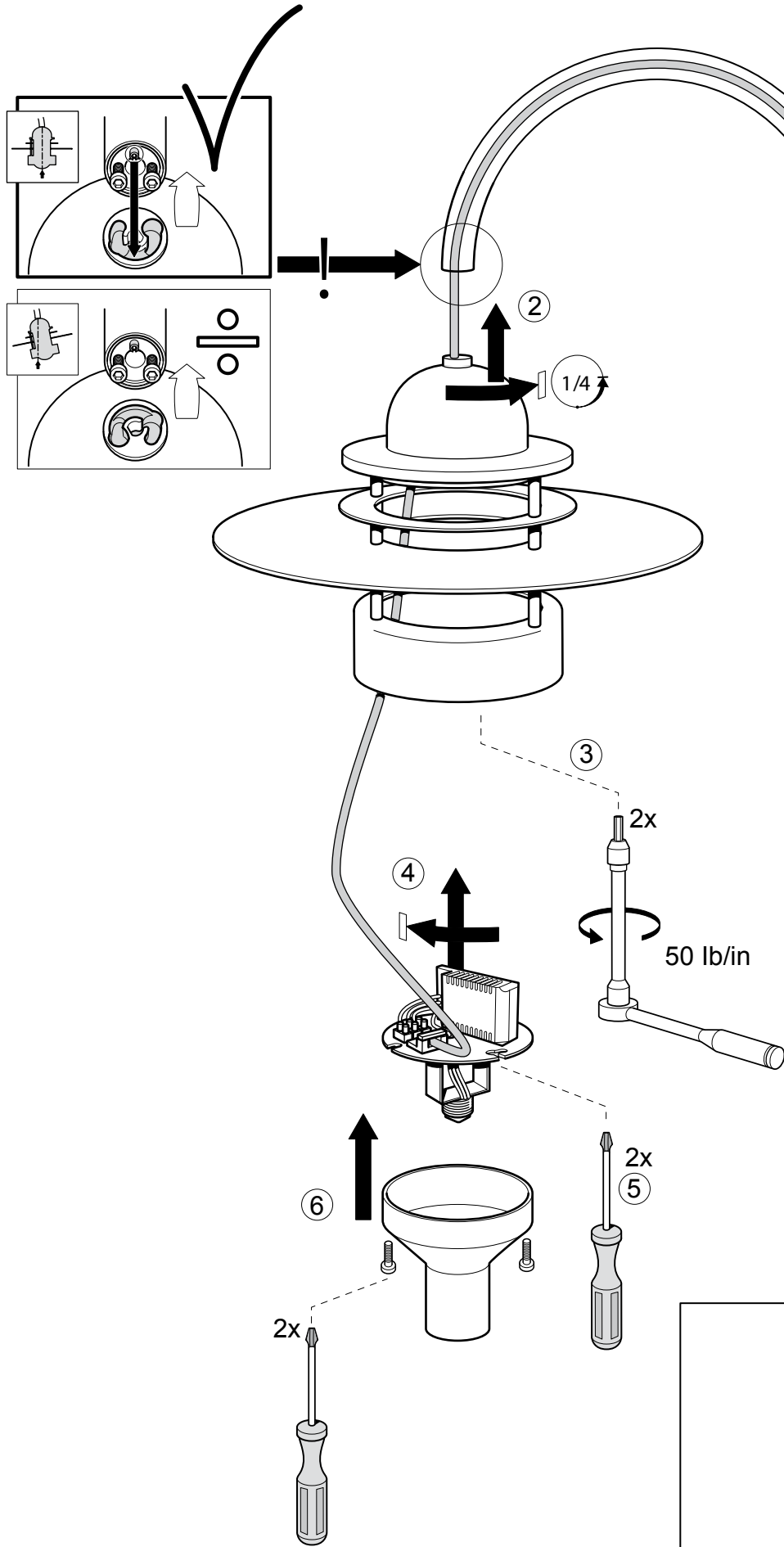
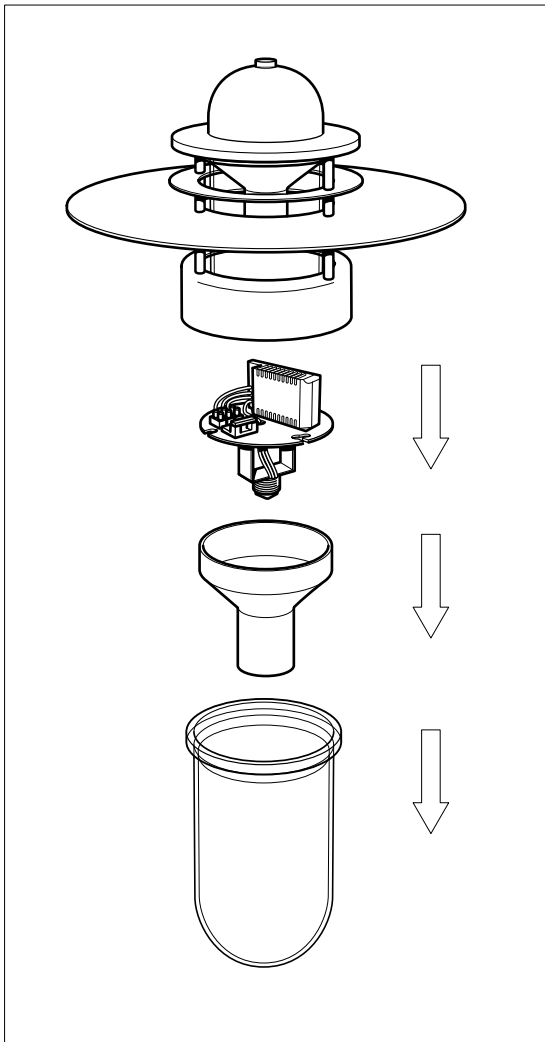
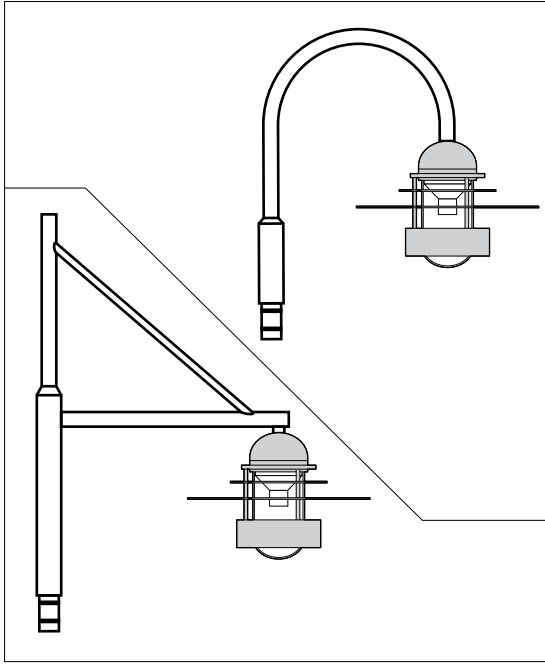

#### Lamp Replacement Labels

This luminaire may have different light source options.

The Installer must ensure that the lamp Replacement Label on the luminaire represents the appropriate light source and control gear.

During installation the installer must delete, with a permanent marker, the lamp wattages that do not apply.

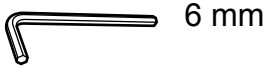
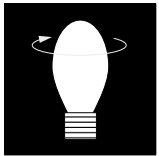

Do NOT remove screws !!

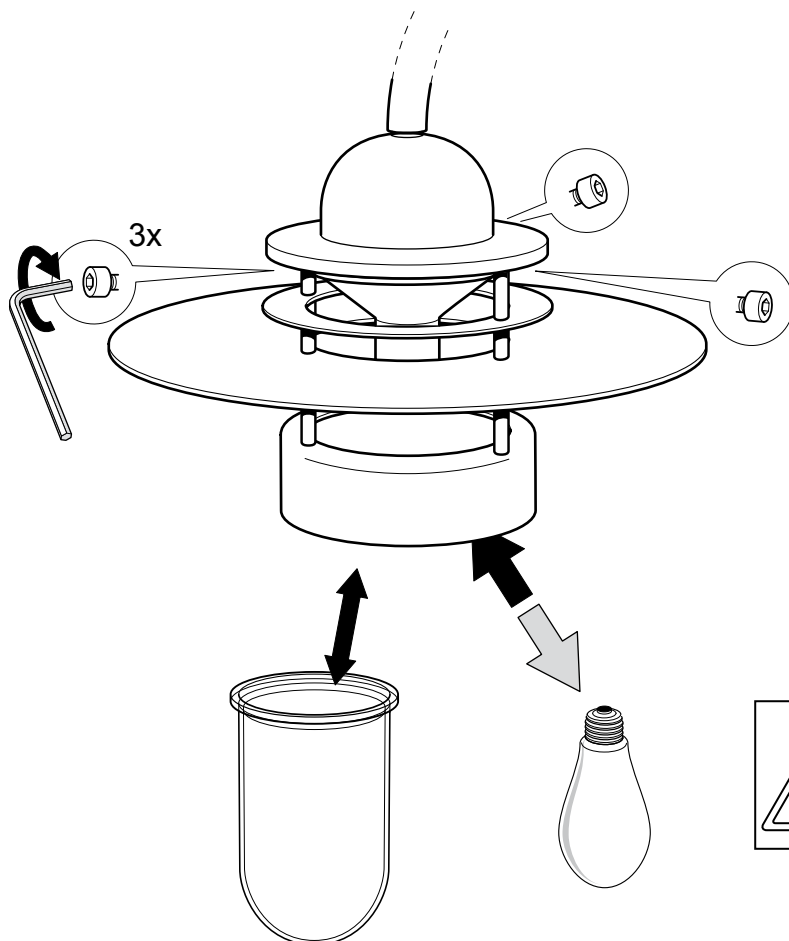

Use only light source in accordance to the lamp replacement label on the luminaire