

Nyhavn Wall

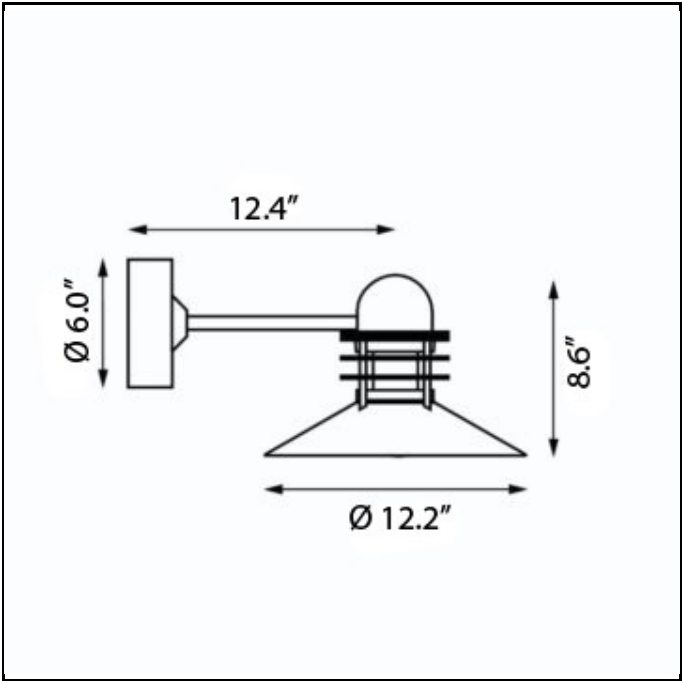

Design	Alfred Homann & Ole V. Kjær
Concept	The conical shade ensures comfortable light that is directed downwards in a wide beam. The shade interior has a white matte painted surface, ensuring uniform light distribution. The rings ensure that a stray light is controlled, and direct a small amount of light onto the top side of the shade for self-illumination.
Finish	Copper, brushed. Natural painted aluminum, powder coated or white, wet painted.
Material	Shades: Spun aluminum or spun copper. Diffuser: Clear glass (INC) or partly frosted glass (CF). Top: Spun aluminum or spun copper. Mounting box: Die cast aluminum. Mounting box cover: Spun aluminum or spun copper. Arm: Copper plated, red brass or steel.
Mounting	Surface: Mounted directly to finished surface over a recessed 4" octagonal junction box.
Weight	Max. 11 lbs.
Label	cULus, Wet location. IBEW.

Product Code	Light source	Voltage	Finish	Diff./Encl./Glass
NYW	1/100W/A-19/CL medium	120-277V	COP	CLEAR
	1/15W LED/A-19/medium	120V	NAT PAINT ALU	PARTLY FROSTED
	1/18W/CF GX24q-2		WHT	

Specification notes
a. CF variant provided with one 120-277V ballast.
b. CF variant provided with partly frosted glass diffuser.
c. Incandescent variant provided with clear glass diffuser.
d. Incandescent variant only available in 120V.

Nyhavn Wall

NYW-1-100W-INC

PRODUCT SPECIFICATION

Product description

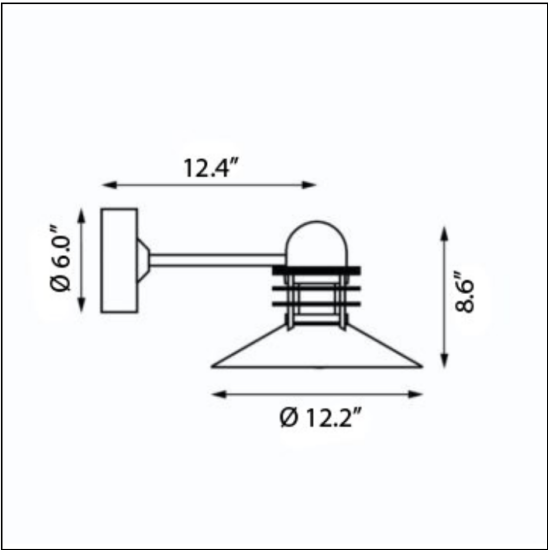
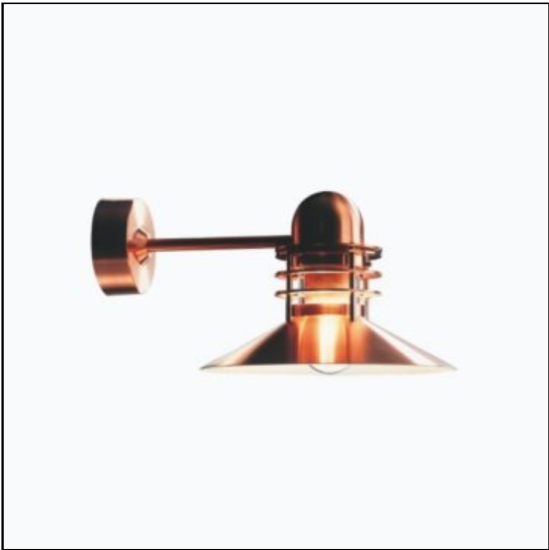

Design Alfred Homann & Ole V. Kjær

Concept The conical shade ensures comfortable light that is directed downwards in a wide beam. The shade interior has a white matte painted surface, ensuring uniform light distribution. The rings ensure that a stray light is controlled, and direct a small amount of light onto the top side of the shade for self-illumination.

Finish Copper, brushed. Natural painted aluminum, powder coated or white, wet painted.

Material Shades: Spun aluminum or spun copper. Diffuser: Clear glass (INC) or partly frosted glass (CF). Top: Spun aluminum or spun copper. Mounting box: Die cast aluminum. Mounting box cover: Spun aluminum or spun copper. Arm: Copper plated, red brass or steel.

Mounting Surface: Mounted directly to finished surface over a recessed 4" octagonal junction box.

Weight Max. 11 lbs.

Label cULus, Wet location. IBEW.

Product Code	Light source	Voltage	Finish	Diff./Encl./Glass
NYW	1/100W/A-19/CL medium	120-277V	COP	CLEAR
	1/15W LED/A-19/medium	120V	NAT PAINT ALU	PARTLY FROSTED
	1/18W/CF GX24q-2		WHT	

Specification notes

- a. CF variant provided with one 120-277V ballast.
- b. CF variant provided with partly frosted glass diffuser.
- c. Incandescent variant provided with clear glass diffuser.
- d. Incandescent variant only available in 120V.

Material description

NOTE:
COPPER VARIANT IS MADE OF UNTREATED COPPER THAT WILL DEVELOP A VERDIGRIS PATINA

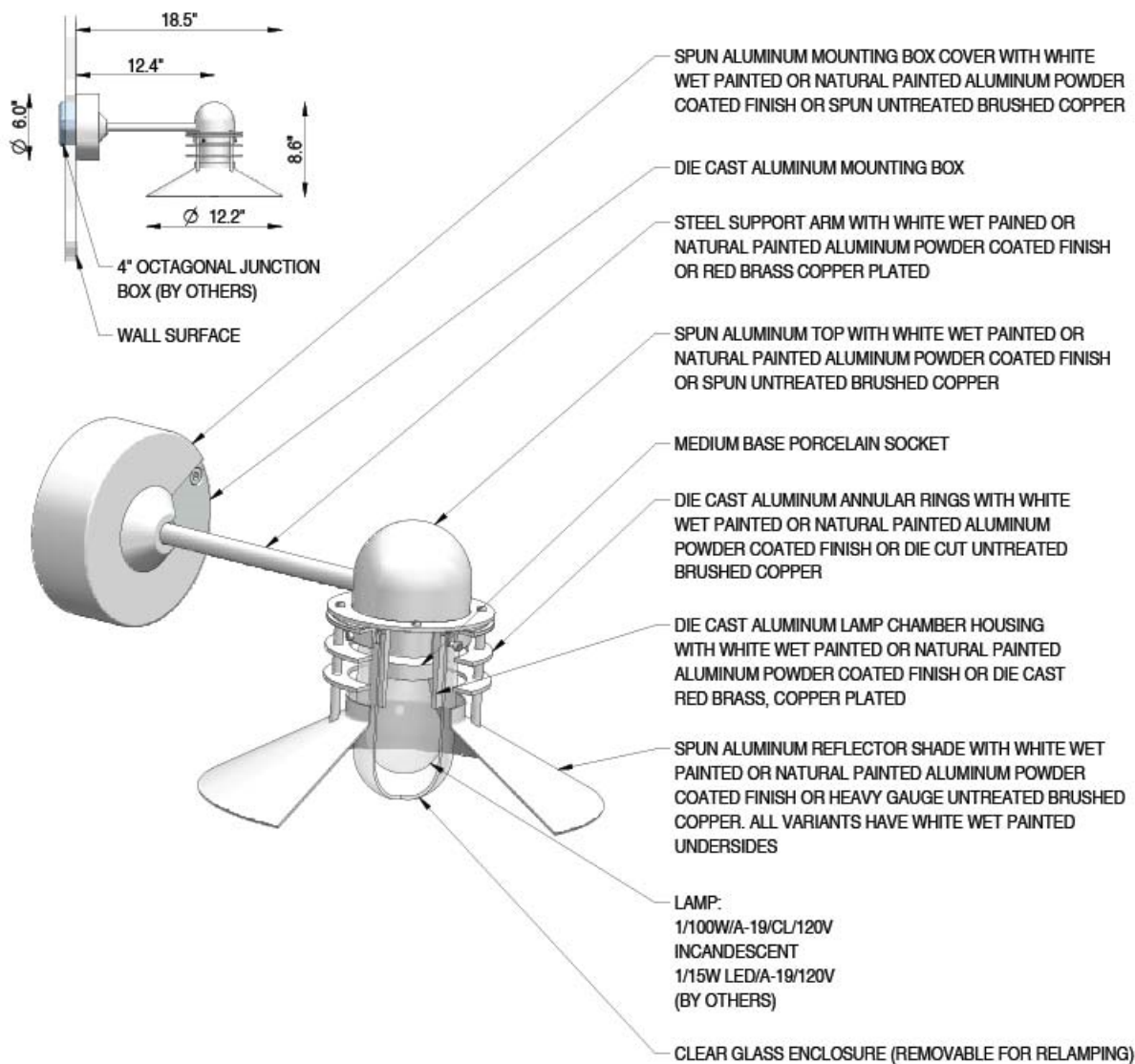

Nyhavn Wall

NYW-1-100W-INC

PRODUCT SPECIFICATION

Light Measurements

Photometric Report: NYW-1-100W-INC
Report No.: Louis Poulsen Lighting A/S
Poulsen Report No.: NYW-1-100W-INC
Luminaire: NYHAVN WALL
Lamp: 1/100W/INC/A-19
Efficiency: 71%
Description: All data shown are per 1750 lumens. This report can be used for calculation on all versions listed below. Use only actual lumen data calculating.

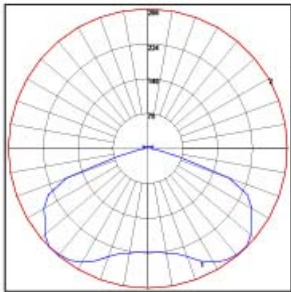

Candlepower Distribution	
Vertical Angle	Candela
0	222.4
5	221.7
15	232.2
25	265.3
35	291.6
45	298.2
55	268.1
65	234.7
75	70.1
90	8.4
120	12.6
150	4.0
180	2.0

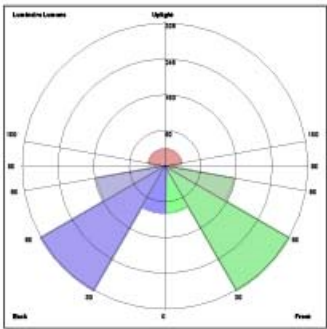

Zonal Lumen Summary

Zone	Lumens	% Lamp	% Fixture
0-20	88.02	5.00	7.10
0-30	210.79	12.00	17.00
0-40	393.18	22.50	31.70
0-60	863.66	49.40	69.70
0-80	1180.65	67.50	95.30
0-90	1193.62	68.20	96.30
10-90	1172.26	67.00	94.60
20-40	305.16	17.40	24.60
20-50	533.55	30.50	43.10
40-70	696.31	39.80	56.20
60-80	316.99	18.10	25.60
70-80	91.16	5.20	7.40
80-90	12.97	0.70	1.00
90-110	18.06	1.00	1.50
90-120	29.63	1.70	2.40
90-130	36.36	2.10	2.90
90-150	42.67	2.40	3.40
90-180	45.73	2.60	3.70
110-180	27.66	1.60	2.20
0-180	1239.34	70.80	100.00

LUMINAIRE CLASSIFICATION SYSTEM (LCS)

	Lumens	% Lamp	% Luminaire
FL - Front-Low (0-30)	105.4	8.0	8.5
FM - Front-Medium (30-60)	326.4	18.7	26.3
FH - Front-High (60-80)	158.5	9.1	12.8
FVH - Front-Very High (80-90)	6.5	0.4	0.5
BL - Back-Low (0-30)	105.4	8.0	8.5
BM - Back-Medium (30-60)	326.4	18.7	26.3
BH - Back-High (60-80)	158.5	9.1	12.8
BVH - Back-Very High (80-90)	6.5	0.4	0.5
UL - Uplight-Low (90-100)	8.6	0.5	0.7
UH - Uplight-High (100-180)	37.1	2.1	3.0
Total	1239.3	71.0	100.0
BUG Rating	B1-U2-G0		

Nyhavn Wall

NYW-1-18W-CF

PRODUCT SPECIFICATION

Product description

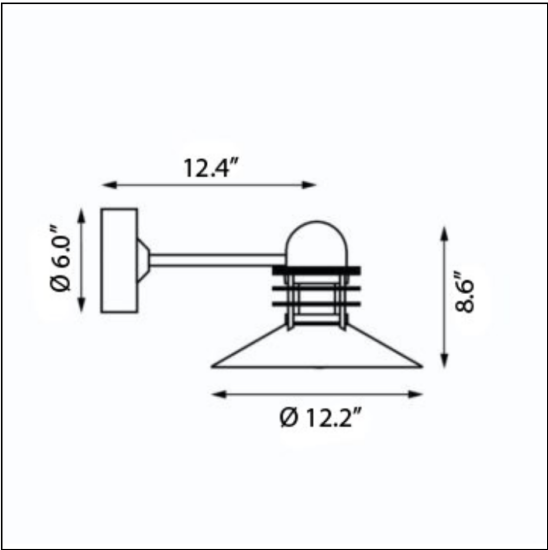
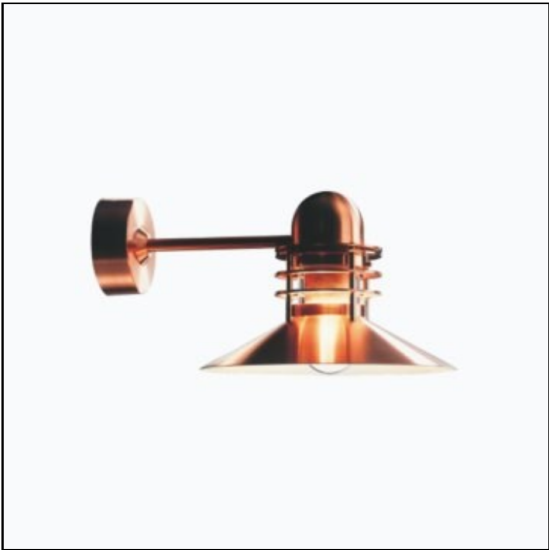

Design Alfred Homann & Ole V. Kjær

Concept The conical shade ensures comfortable light that is directed downwards in a wide beam. The shade interior has a white matte painted surface, ensuring uniform light distribution. The rings ensure that a stray light is controlled, and direct a small amount of light onto the top side of the shade for self-illumination.

Finish Copper, brushed. Natural painted aluminum, powder coated or white, wet painted.

Material Shades: Spun aluminum or spun copper. Diffuser: Clear glass (INC) or partly frosted glass (CF). Top: Spun aluminum or spun copper. Mounting box: Die cast aluminum. Mounting box cover: Spun aluminum or spun copper. Arm: Copper plated, red brass or steel.

Mounting Surface: Mounted directly to finished surface over a recessed 4" octagonal junction box.

Weight Max. 11 lbs.

Label cULus, Wet location. IBEW.

Product Code	Light source	Voltage	Finish	Diff./Encl./Glass
NYW	1/100W/A-19/CL medium	120-277V	COP	CLEAR
	1/15W LED/A-19/medium	120V	NAT PAINT ALU	PARTLY FROSTED
	1/18W/CF GX24q-2		WHT	

Specification notes

- a. CF variant provided with one 120-277V ballast.
- b. CF variant provided with partly frosted glass diffuser.
- c. Incandescent variant provided with clear glass diffuser.
- d. Incandescent variant only available in 120V.

Material description

NOTE:
COPPER VARIANT IS MADE OF UNTREATED COPPER THAT WILL DEVELOP A VERDIGRIS PATINA

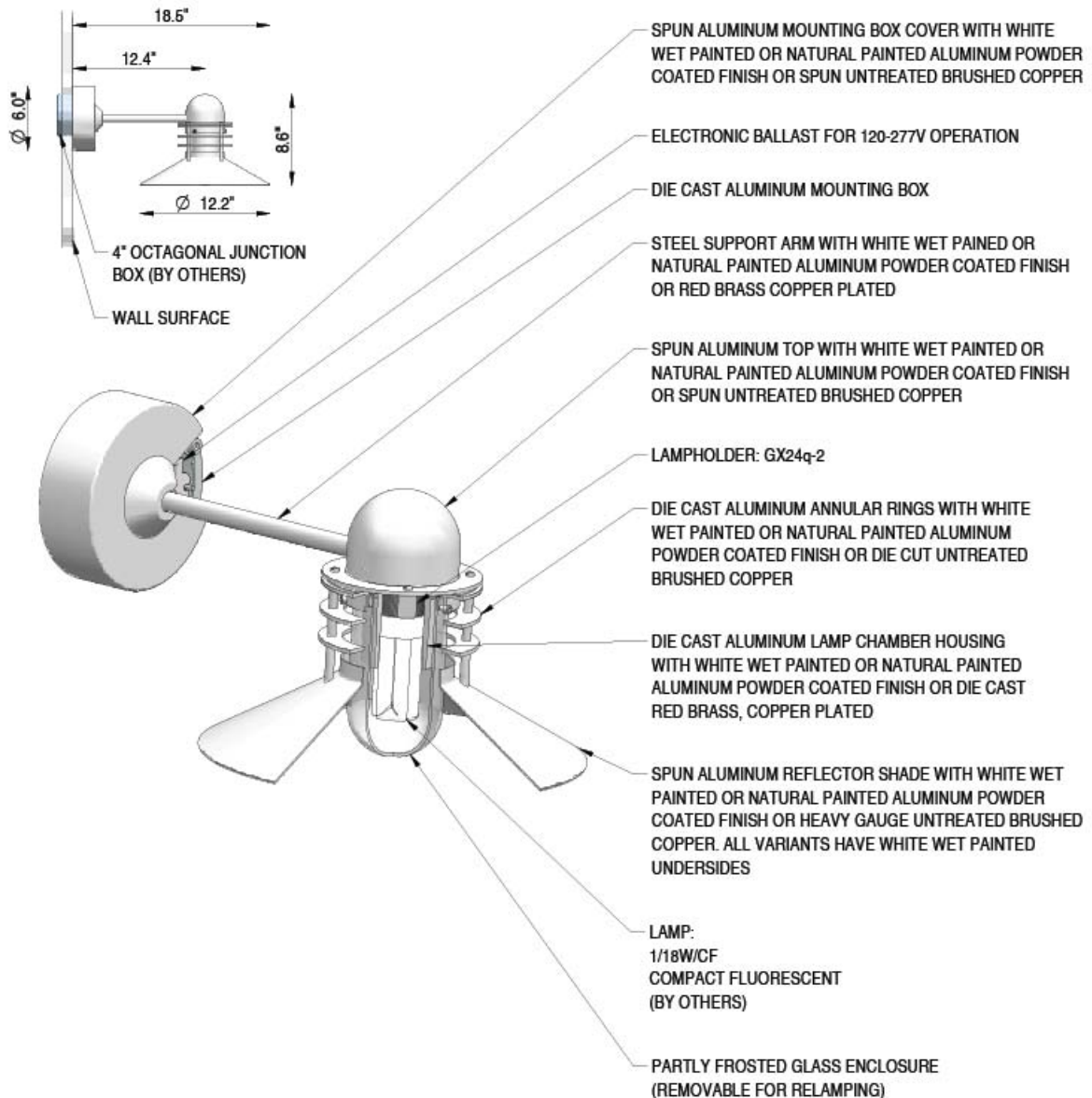

Nyhavn Wall

NYW-1-18W-CF

PRODUCT SPECIFICATION

Light Measurements

Photometric Report: NYW-1-18W-CF
Report No.: Louis Poulsen Lighting A/S
Poulsen Report No.: NYW-1-18W-CF
Luminaire: NYHAVN WALL
Lamp: 1/18W/CF/GX24q-2
Efficiency: 47%
Description: All data shown are per 1200 lumens. This report can be used for calculation on all versions listed below. Use only actual lumen data calculating.

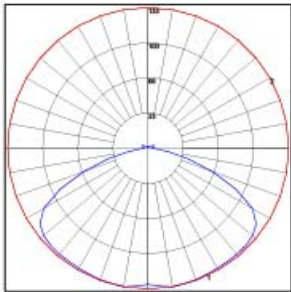

Candlepower Distribution	
Vertical Angle	Candela
0	128.8
5	130.9
15	132.7
25	131.3
35	130.6
45	130.3
55	124.7
65	91.3
75	39.0
90	3.4
120	4.6
150	1.8
180	0.9

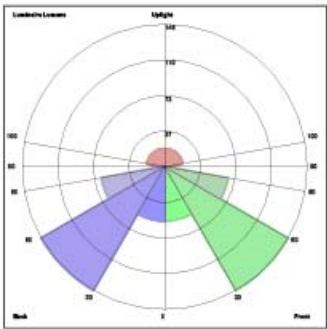

Zonal Lumen Summary

Zone	Lumens	% Lamp	% Fixture
0-20	50.10	4.20	8.80
0-30	110.89	9.20	19.50
0-40	192.94	16.10	33.90
0-60	403.88	33.70	71.00
0-80	535.71	44.60	94.20
0-90	546.39	45.50	96.00
10-90	533.85	44.50	93.80
20-40	142.84	11.90	25.10
20-50	243.50	20.30	42.80
40-70	300.17	25.00	52.80
60-80	131.83	11.00	23.20
70-80	42.60	3.50	7.50
80-90	10.68	0.90	1.90
90-110	9.38	0.80	1.60
90-120	15.14	1.30	2.70
90-130	18.18	1.50	3.20
90-150	21.19	1.80	3.70
90-180	22.59	1.90	4.00
110-180	13.20	1.10	2.30
0-180	568.97	47.40	100.00

LUMINAIRE CLASSIFICATION SYSTEM (LCS)

	Lumens	% Lamp	% Luminaire
FL - Front-Low (0-30)	55.4	4.8	9.7
FM - Front-Medium (30-60)	148.5	12.2	25.8
FH - Front-High (60-80)	85.9	5.5	11.6
FVH - Front-Very High (80-90)	5.3	0.4	0.9
BL - Back-Low (0-30)	55.4	4.8	9.7
BM - Back-Medium (30-60)	148.5	12.2	25.8
BH - Back-High (60-80)	85.9	5.5	11.6
BVH - Back-Very High (80-90)	5.3	0.4	0.9
UL - Uplight-Low (90-100)	4.3	0.4	0.7
UH - Uplight-High (100-180)	18.3	1.5	3.2
Total	568.8	47.3	100.0
BUG Rating	B1-U2-G1		

Design Alfred Homann

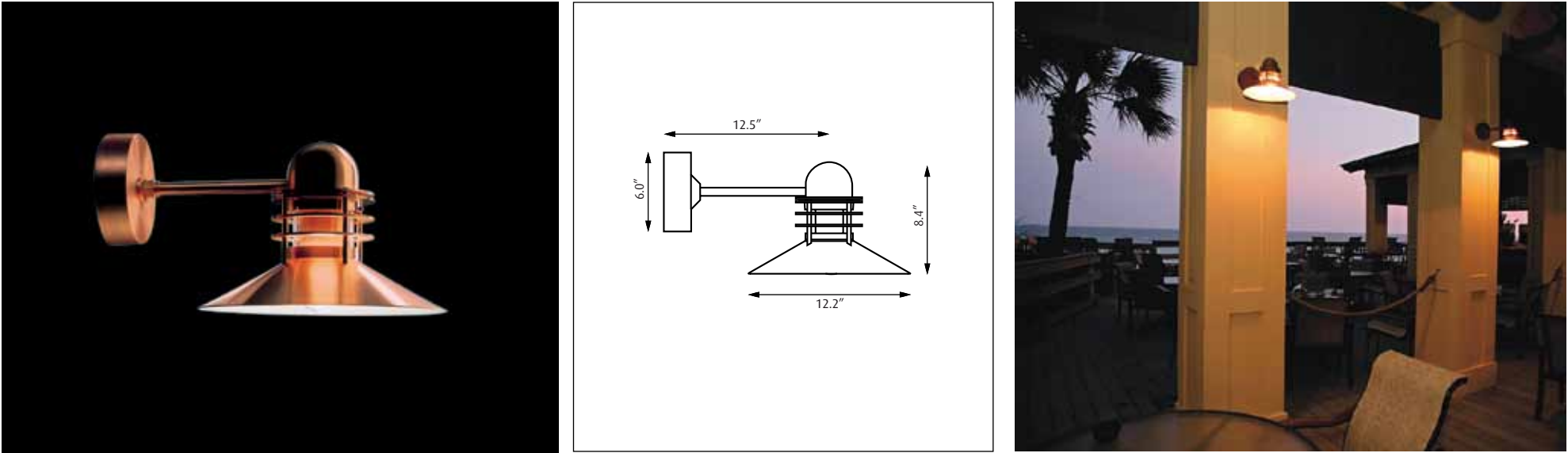

Light source	Voltage	Weight	Electric shock protection	Ingress protection
1/100W/A-19/CL medium 1/18W/CF GX 24q-2	120V 120-277V	11 Lbs 11 Lbs	Cl. I, grounded Cl. I, grounded	IP 44, Wet location IP 44, Wet location

Recommended cleaning substances:
Wipe off dust wiht a dry, soft cloth.

Remove greasy spots etc. with a soft cloth dampened in lukewarm water (<122° F/ 50° C) with a mild detergent.

Warning:
Scouring powder and similar substances will scratch surfaces.

All installation is subject to local code and jurisdiction.

Caution - Risk of fire.
Consult a qualified electrician to ensure correct branch circuit conductor.



6mm

3mm

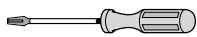

38301-I1

CONNECT WIRES TO JUNCTION BOX IN WALL

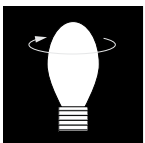
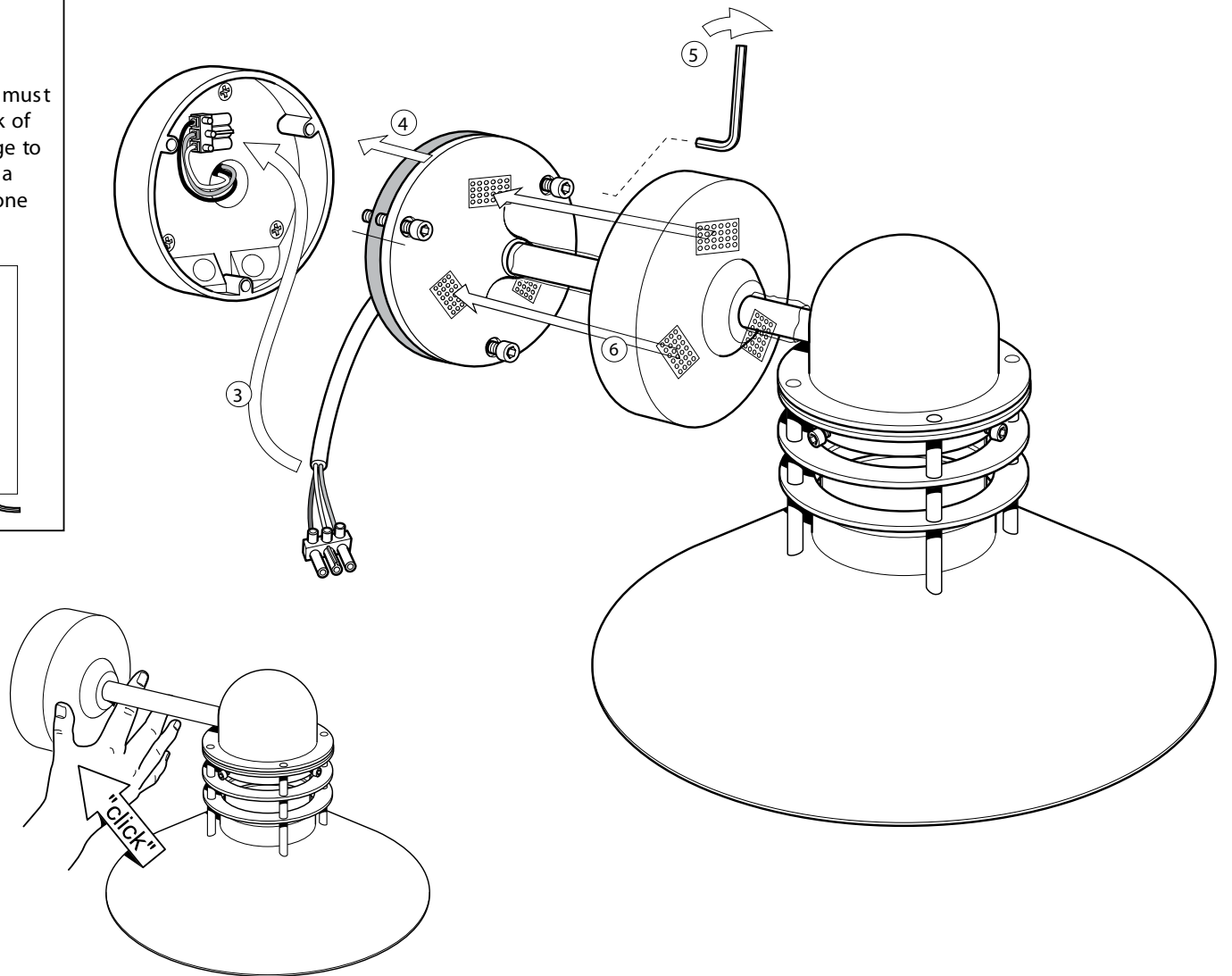
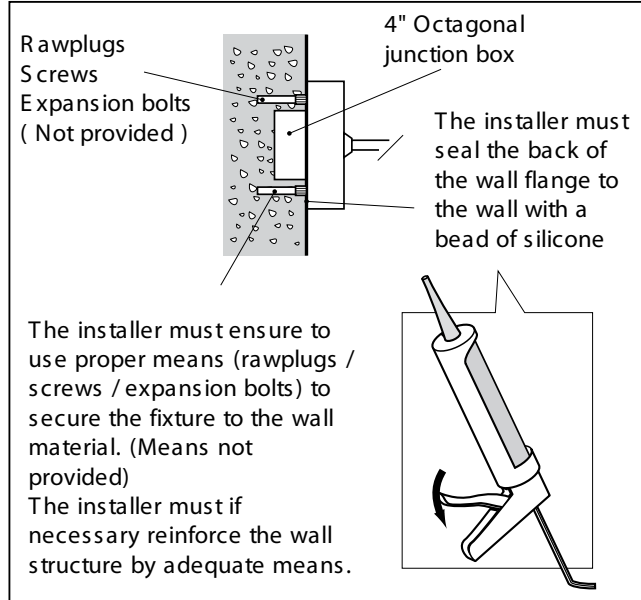
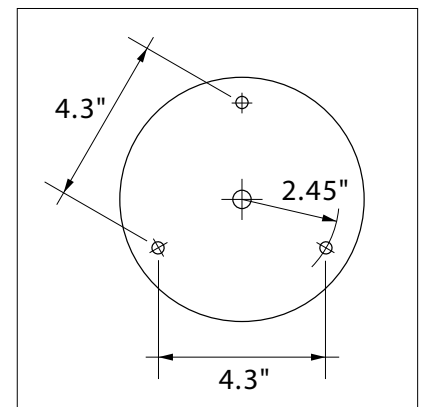
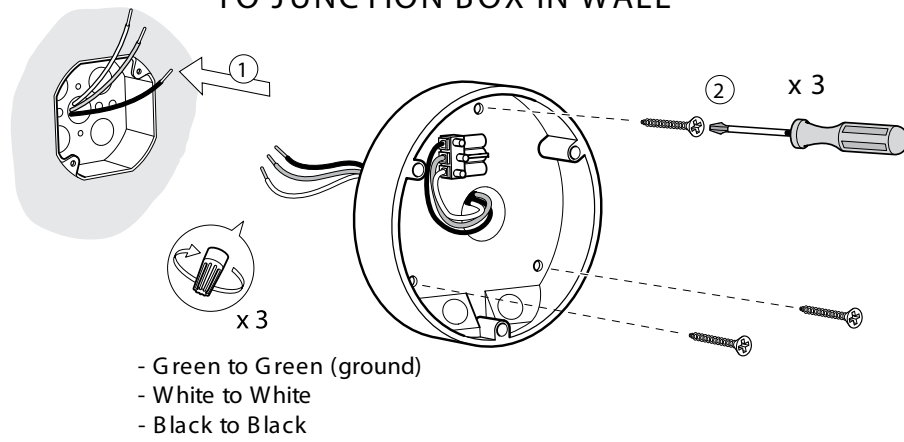

3 mm

