

LP Icon Mini Wall

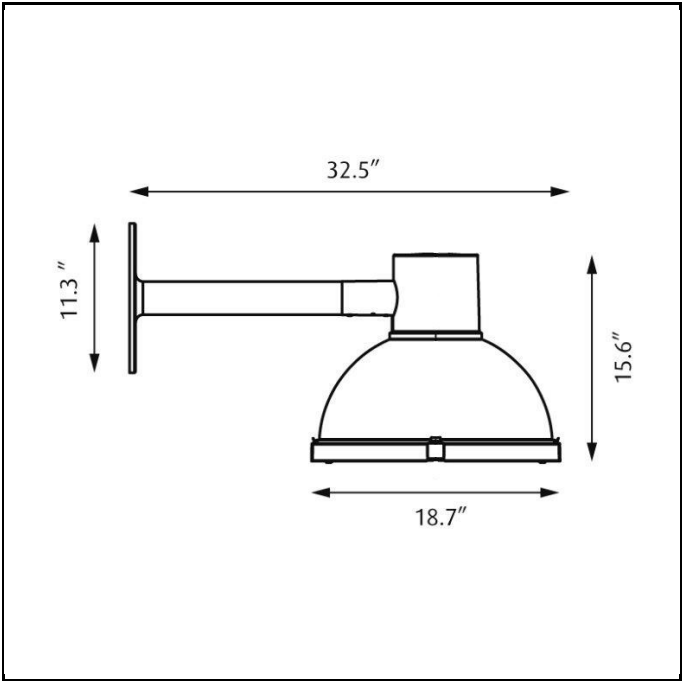

- Design

Mads Odgård
- Concept

The fixture provides mainly direct downward illumination. In the opal version the shade is lit up from within and creates a soft diffuse upwards light. In the basic version the shade is opaque. Depending on the choice of reflector, the downward lighting characteristics will vary. The reflector types have been designed in two variations to provide either asymmetrical or symmetrical distributions of light.
- Finish

Natural painted aluminum, powder coated.
- Material

Enclosure: Injection molded opaque ASA (basic) or impact resistant acrylic (opal). Reflector: Pre-anodized segmented high reflectance aluminum (MH) or metallized plastic (LED). Bottom enclosure: Silk screened heat tempered glass. Housing: Die cast aluminum. Mounting plate: Cast aluminum. Arm: Extruded aluminum.
- Mounting

Surface: Mounted directly to finished surface over a recessed 4" octagonal junction box.
- Weight

Max. 35 lbs.
- Label

cULus. Wet location. IBEW.

Product Code	Light source	Voltage	Finish	Distribution/Trim	Reflector/Optics	Shade
LPI-W	1/100W/MH/ED-17 medium	120/208/240/277V	NAT PAINT ALU	T3	MATTE	BASIC
	1/150W/MH/ED-17 medium	120-277V			POLISHED	OPAL
	57W LED/3000K					
	57W LED/4000K					

Specification notes
a. 150W variant provided with a 120/208/240/277V ballast.
b. 100W variant provided with a 120-277V ballast.
c. 57W LED variant provided with a 120-277V dimmable driver (0-10V).
d. MH variants only available with polished reflector.

Design Jens Møller-Jensen

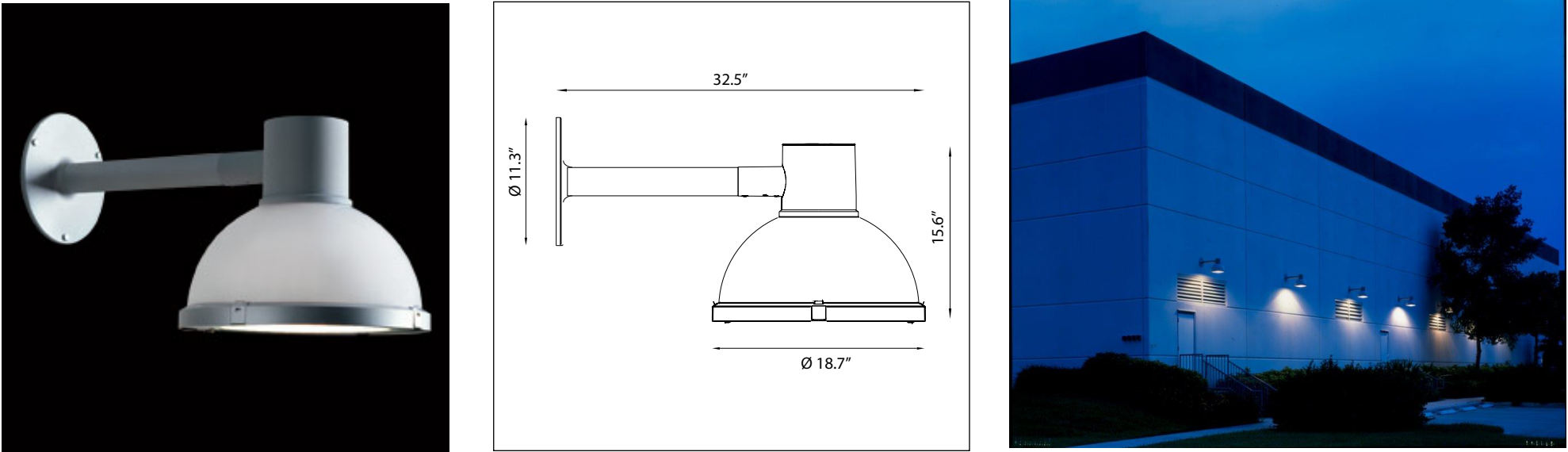

Light source	Voltage	Weight	Electric shock protection	Ingress protection
1/100W/MH/ED-17 medium 1/150W/MH/ED-17 medium	120-277V 120/208/240/277V	35 Lbs	Cl. I	IP 66, wet location

Recommended cleaning substances:

Wipe off dust wiht a dry, soft cloth. Remove greasy spots etc. with a soft cloth dampe-
ned in lukewarm water (<122° F/ 50° C) with a mild detergent.

Warning: Scouring powder and similar substances will scratch surfaces.

All installation is subject to local code and jurisdiction.

Consult a qualified electrician to ensure correct branch circuit conductor.

The installer must ensure that the foundation is stable and can support the luminiare’s
weight.

The Installer must use proper means to secure the luminiare to the ground.

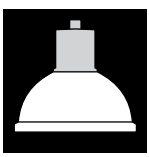
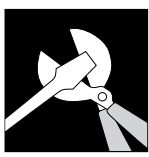

5 mm

1

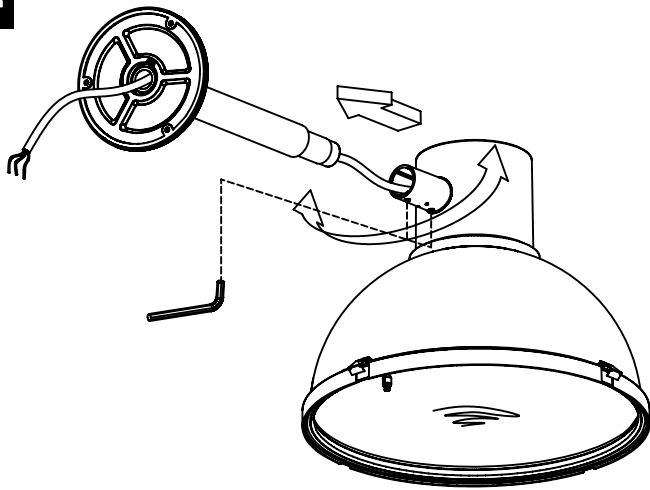

Feed wire provided through the arm and slide luminaire over arm, then secure by tightening two hex set screws on the luminaire head as shown.

2

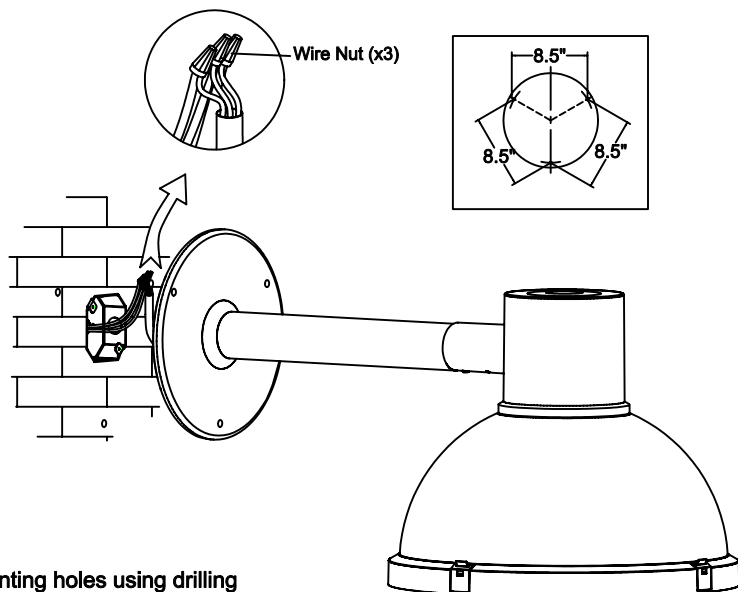

Drill mounting holes using drilling template (provided). Ensure that the power is turned off and wire the fixture: White to Common, Black to Line and Green to Ground

3

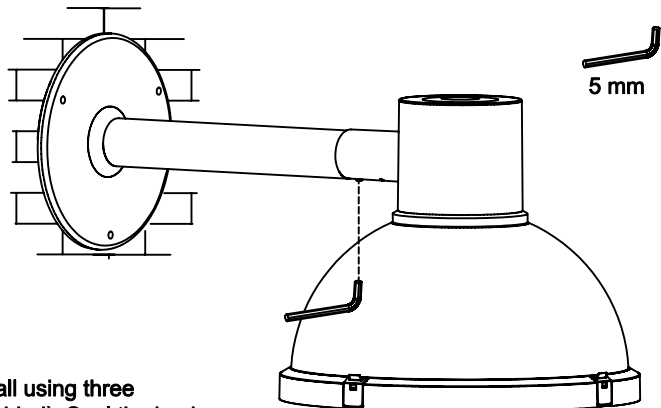

Secure to the wall using three screws (not provided). Seal the back of the flange to the wall with a bead of silicone. Loosen two hex set screws on the luminaire head, level the luminaire so that the glass and the ground are parallel and then secure by tightening as shown.

4

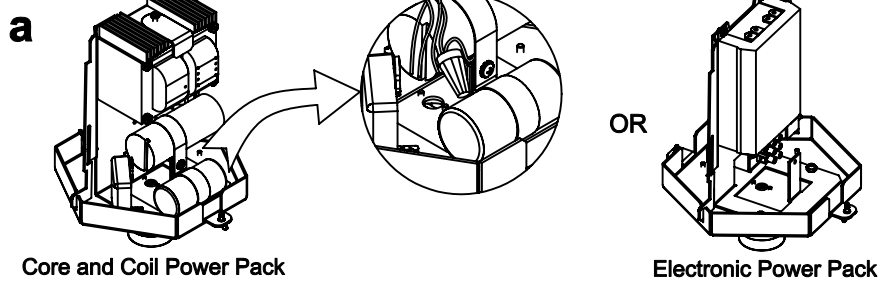

Core and Coil Power Pack

Electronic Power Pack

Core and Coil Power Pack is pre wired for 277 Volts. To choose voltage disconnect orange wire nut from the jumper from terminal block and the 277V line from ballast. Using the orange wire nut connect the jumper to the ballast voltage line needed. Voltage will be labeled on the wire: 120, 208, 240 or 277V.

b

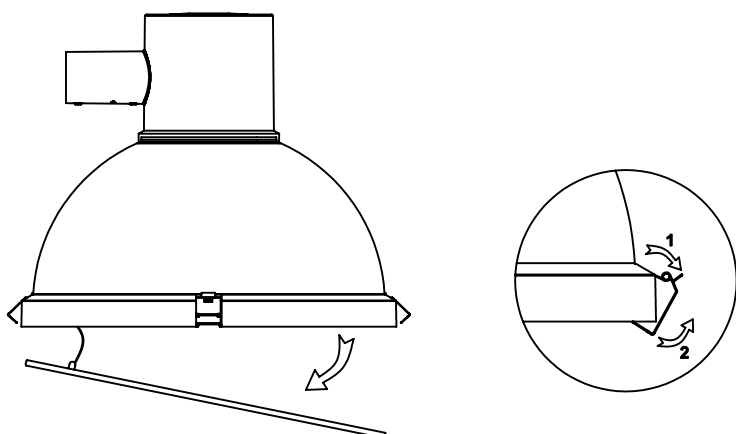

Open luminaire by unlatching four mounting clips and lowering the glass. First pull down on the top of the clip and then swing the bottom of the clip upward as shown. NO TOOLS NEEDED.

5

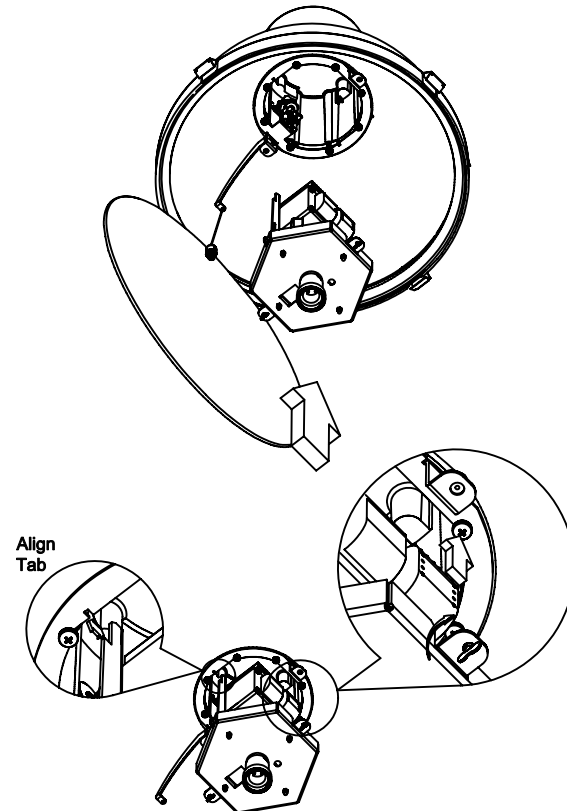

Align quick plugs, slide power pack into place and turn mounting tabs one quarter turn to secure. All electrical connections are made.

6

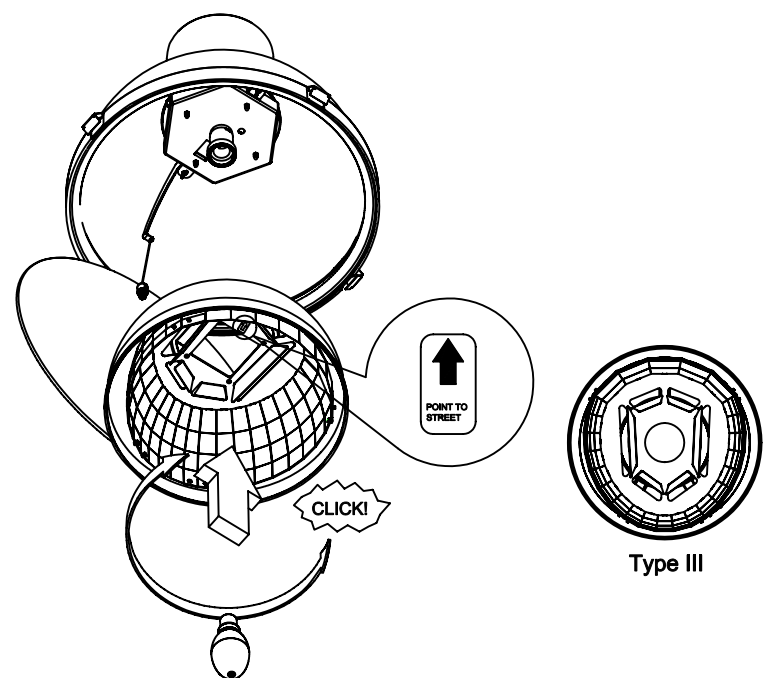

Type III

Push reflector up into luminaire until it "CLICKS" into place. Insure that the reflector is in the proper orientation (Type III only). Then install the proper lamp (not included).

7

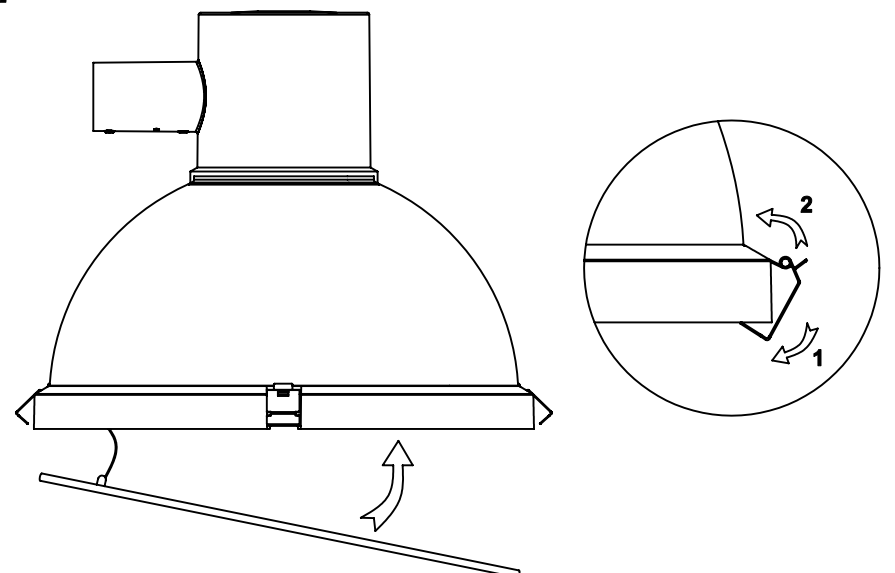

Place glass back into place and secure it using four mounting clips.

Design Jens Møller-Jensen

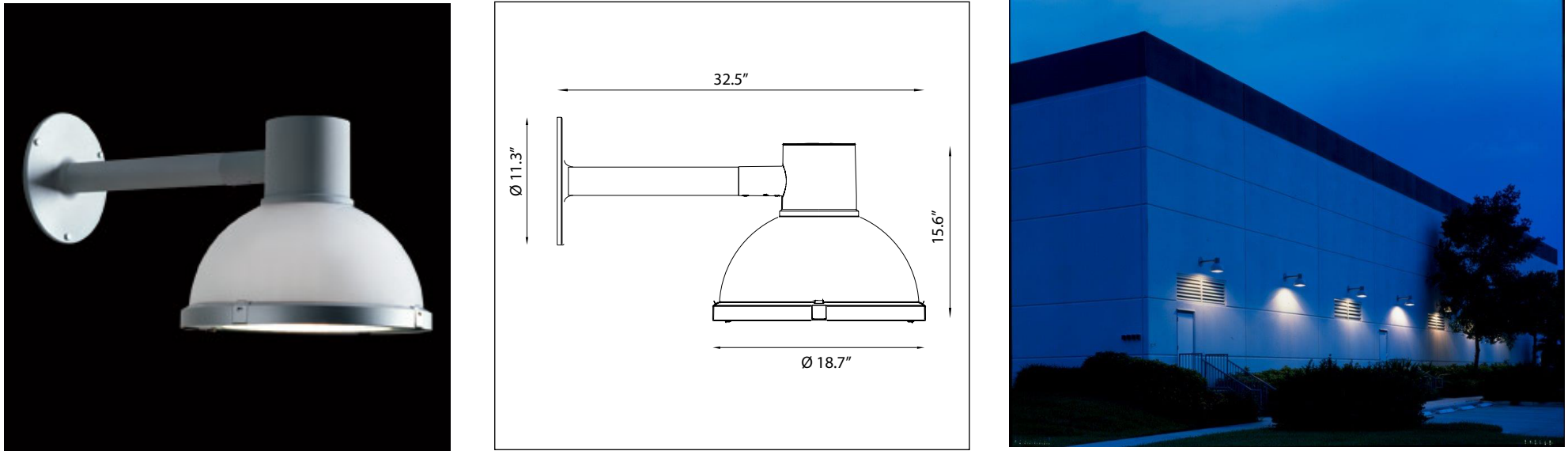

Light source	Voltage	Weight	Electric shock protection	Ingress protection
57W/LED/3000K 57W/LED/4000K	120-277V	35 Lbs	Cl. I	IP 66, wet location

Recommended cleaning substances:

Wipe off dust wiht a dry, soft cloth. Remove greasy spots etc. with a soft cloth dampe-
ned in lukewarm water (<122° F/ 50° C) with a mild detergent.

Warning: Scouring powder and similar substances will scratch surfaces.

All installation is subject to local code and jurisdiction.

Consult a qualified electrician to ensure correct branch circuit conductor.

The installer must ensure that the foundation is stable and can support the luminiare’s weight.

The Installer must use proper means to secure the luminiare to the ground.

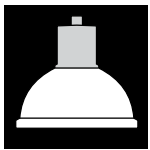

5 mm

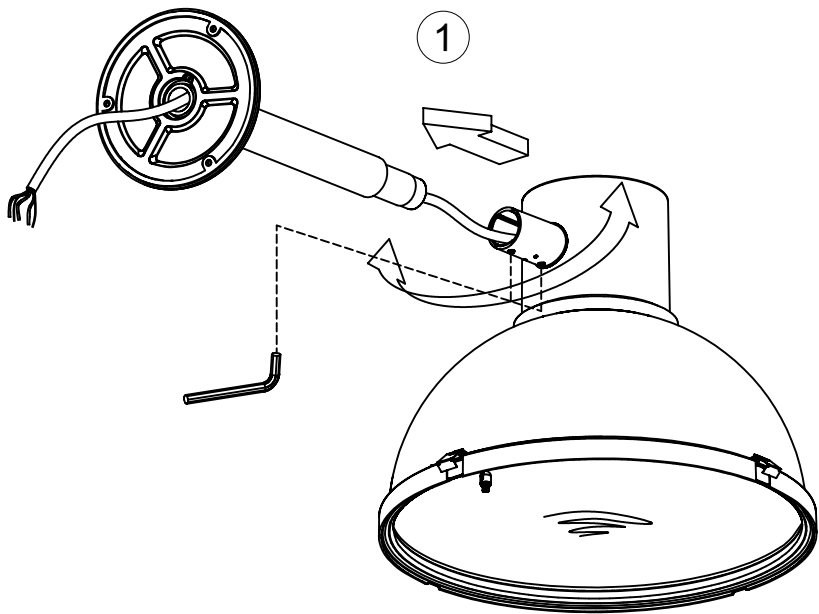

Feed wire provided through the arm and slide luminaire over arm, then secure by tightening two hex set screws on the luminaire head as shown.

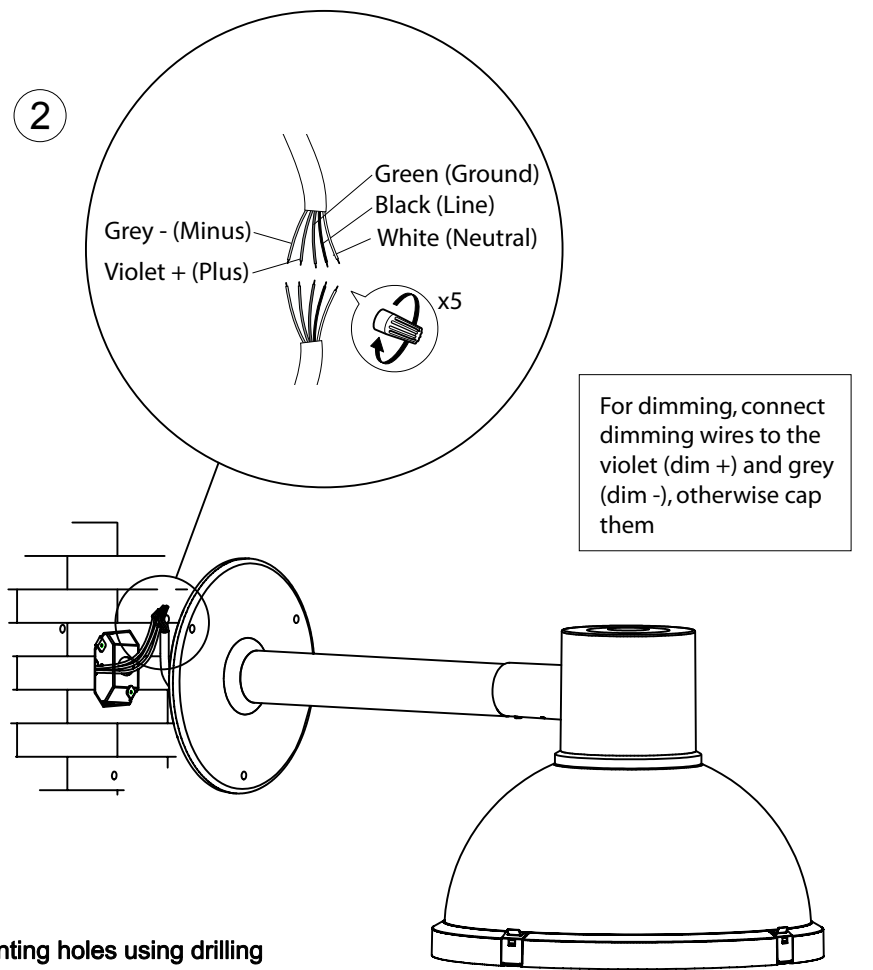

Drill mounting holes using drilling template (provided). Ensure that the power is turned off and wire the fixture: White to Common, Black to Line and Green to Ground

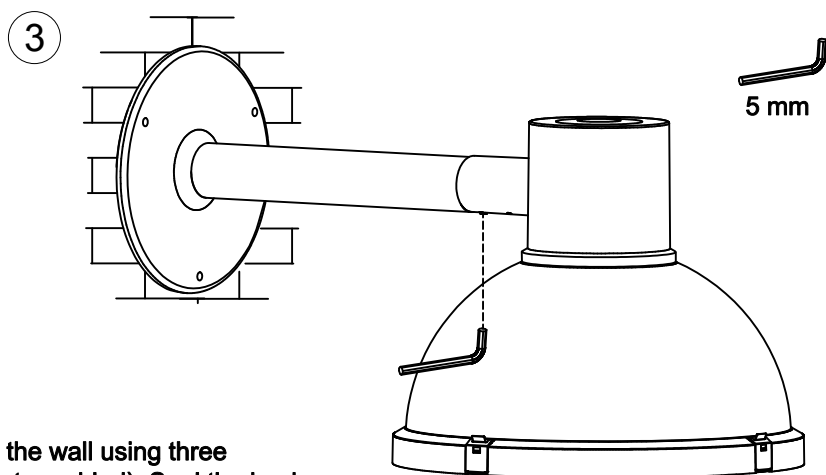

Secure to the wall using three screws (not provided). Seal the back of the flange to the wall with a bead of silicone. Loosen two hex set screws on the luminaire head, level the luminaire so that the glass and the ground are parallel and then secure by tightening as shown.

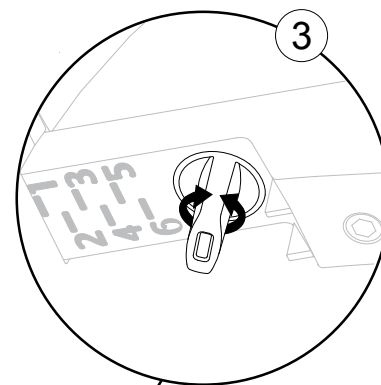

Reflector Adjustments

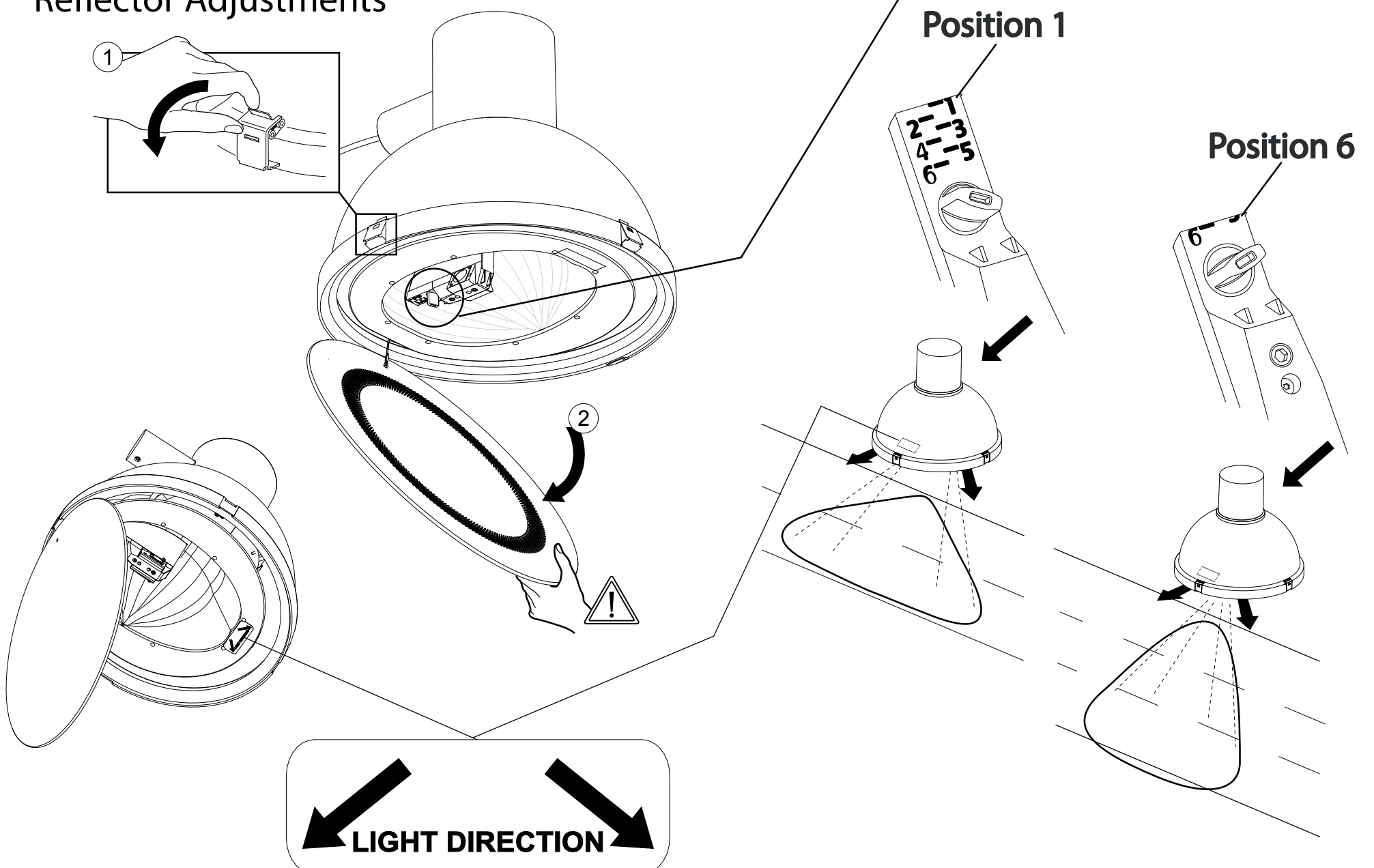

LP Icon Mini Wall

LPI-W-OPAL

PRODUCT SPECIFICATION

Product description

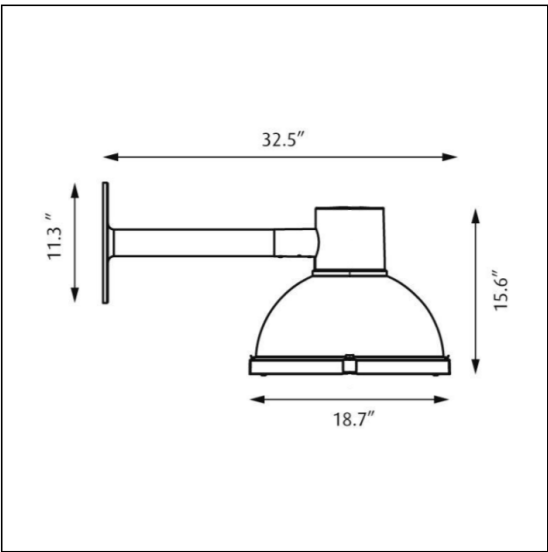

Design Mads Odgård

Concept The fixture provides mainly direct downward illumination. In the opal version the shade is lit up from within and creates a soft diffuse upwards light. In the basic version the shade is opaque. Depending on the choice of reflector, the downward lighting characteristics will vary. The reflector types have been designed in two variations to provide either asymmetrical or symmetrical distributions of light.

Finish Natural painted aluminum, powder coated.

Material Enclosure: Injection molded opaque ASA (basic) or impact resistant acrylic (opal). Reflector: Pre-anodized segmented high reflectance aluminum (MH) or metallized plastic (LED). Bottom enclosure: Silk screened heat tempered glass. Housing: Die cast aluminum. Mounting plate: Cast aluminum. Arm: Extruded aluminum.

Mounting Surface: Mounted directly to finished surface over a recessed 4" octagonal junction box.

Weight Max. 35 lbs.

Label cULus. Wet location. IBEW.

Product Code	Light source	Voltage	Finish	Distribution/Trim	Reflector/Optics	Shade
LPI-W	1/100W/MH/ED-17 medium	120/208/240/277V	NAT PAINT ALU	T3	MATTE	BASIC
	1/150W/MH/ED-17 medium	120-277V			POLISHED	OPAL
	57W LED/3000K					
	57W LED/4000K					

Specification notes

- a. 150W variant provided with a 120/208/240/277V ballast.
- b. 100W variant provided with a 120-277V ballast.
- c. 57W LED variant provided with a 120-277V dimmable driver (0-10V).
- d. MH variants only available with polished reflector.

LP Icon Mini Wall

LPI-W-OPAL

PRODUCT SPECIFICATION

Material description

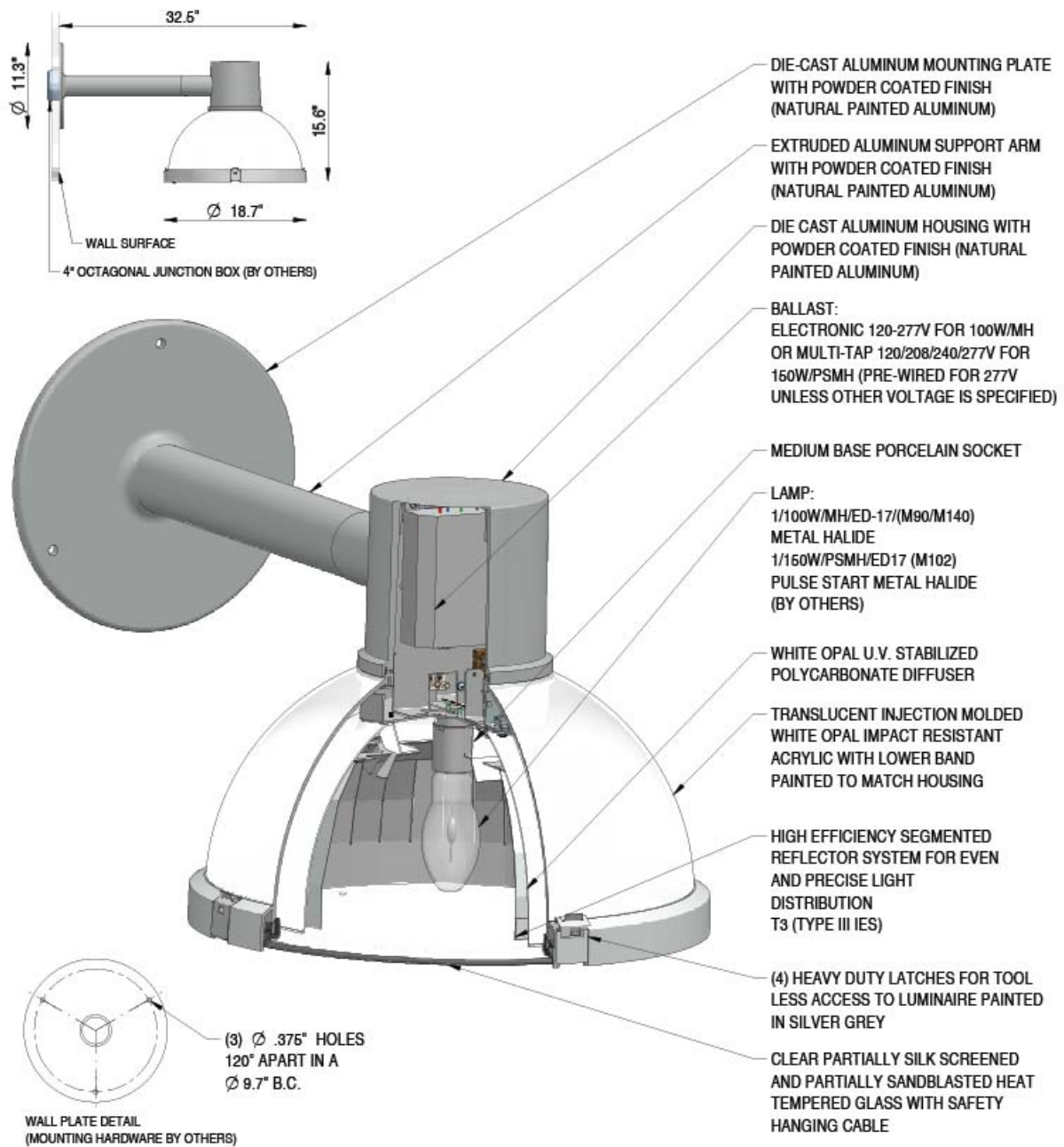

LP Icon Mini Wall

LPI-W-OPAL

PRODUCT SPECIFICATION

Light Measurements

Photometric Report: LPI-W-1-150W-MH-T5-OPAL

Report No.: ITL53417

Poulsen Report No.: LPI-W-1-150W-MH-T5-OPAL

Luminaire: LP ICON MINI WALL

Lamp: 1/150W/MH/ED17 MEDIUM

Efficiency: 77%

Description: All data shown are per 14000 lumens. This report can be used for calculation on all versions listed below. Use only actual lumen data calculating.

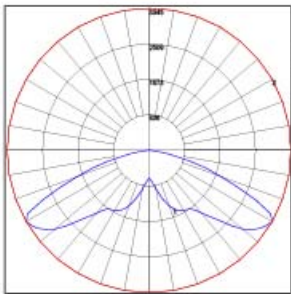

Candlepower Distribution	
Vertical Angle	Candela
0	813.7
5	885.4
15	1048.3
25	1409.4
35	1822.8
45	2246.7
55	3162.8
65	2763.0
75	1008.0
90	21.2
125	33.6
155	36.9
180	36.9

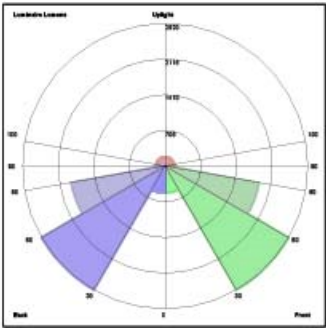

Zonal Lumen Summary

Zone	Lumens	% Lamp	% Fixture
0-20	375.66	2.70	3.50
0-30	1052.93	7.50	9.70
0-40	2099.25	15.00	19.40
0-60	6692.56	47.80	62.00
0-80	10455.95	74.70	96.80
0-90	10598.42	75.70	98.10
10-90	10528.19	75.20	97.50
20-40	1723.59	12.30	16.00
20-50	3501.43	25.00	32.40
40-70	7268.8	51.90	67.30
60-80	3763.39	26.90	34.80
70-80	1087.9	7.80	10.10
80-90	142.47	1.00	1.30
90-110	41.57	0.30	0.40
90-120	72.69	0.50	0.70
90-130	103.50	0.70	1.00
90-150	158.25	1.10	1.50
90-180	201.00	1.40	1.90
110-180	159.44	1.10	1.50
0-180	10799.42	77.10	100.00

LUMINAIRE CLASSIFICATION SYSTEM (LCS)

	Lumens	% Lamp	% Lum
FL - Front-Low (0-30)	526.5	3.8	4.9
FM - Front-Medium (30-60)	2819.8	20.1	26.1
FH - Front-High (60-80)	1881.7	13.4	17.4
FVH - Front-Very High (80-90)	71.2	0.5	0.7
BL - Back-Low (0-30)	526.5	3.8	4.9
BM - Back-Medium (30-60)	2819.8	20.1	26.1
BH - Back-High (60-80)	1881.7	13.4	17.4
BVH - Back-Very High (80-90)	71.2	0.5	0.7
UL - Uplight-Low (90-100)	26.6	0.2	0.2
UH - Uplight-High (100-180)	174.4	1.2	1.6
Total	10799.4	77.0	100.0
BUG Rating	B3-U3-G2		

LP Icon Mini Wall

LPI-W-BASIC

PRODUCT SPECIFICATION

Product description

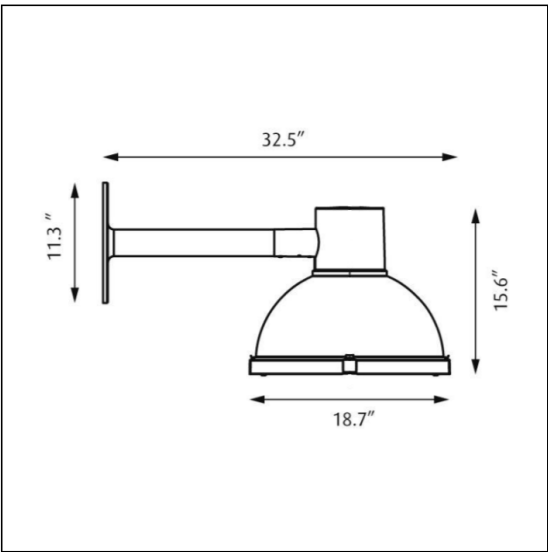

Design	Mads Odgård
Concept	The fixture provides mainly direct downward illumination. In the opal version the shade is lit up from within and creates a soft diffuse upwards light. In the basic version the shade is opaque. Depending on the choice of reflector, the downward lighting characteristics will vary. The reflector types have been designed in two variations to provide either asymmetrical or symmetrical distributions of light.
Finish	Natural painted aluminum, powder coated.
Material	Enclosure: Injection molded opaque ASA (basic) or impact resistant acrylic (opal). Reflector: Pre-anodized segmented high reflectance aluminum (MH) or metallized plastic (LED). Bottom enclosure: Silk screened heat tempered glass. Housing: Die cast aluminum. Mounting plate: Cast aluminum. Arm: Extruded aluminum.
Mounting	Surface: Mounted directly to finished surface over a recessed 4" octagonal junction box.
Weight	Max. 35 lbs.
Label	cULus. Wet location. IBEW.

Product Code	Light source	Voltage	Finish	Distribution/Trim	Reflector/Optics	Shade
LPI-W	1/100W/MH/ED-17 medium	120/208/240/277V	NAT PAINT ALU	T3	MATTE	BASIC
	1/150W/MH/ED-17 medium	120-277V			POLISHED	OPAL
	57W LED/3000K					
	57W LED/4000K					

Specification notes

- a. 150W variant provided with a 120/208/240/277V ballast.
- b. 100W variant provided with a 120-277V ballast.
- c. 57W LED variant provided with a 120-277V dimmable driver (0-10V).
- d. MH variants only available with polished reflector.

LP Icon Mini Wall

LPI-W-BASIC

PRODUCT SPECIFICATION

Material description

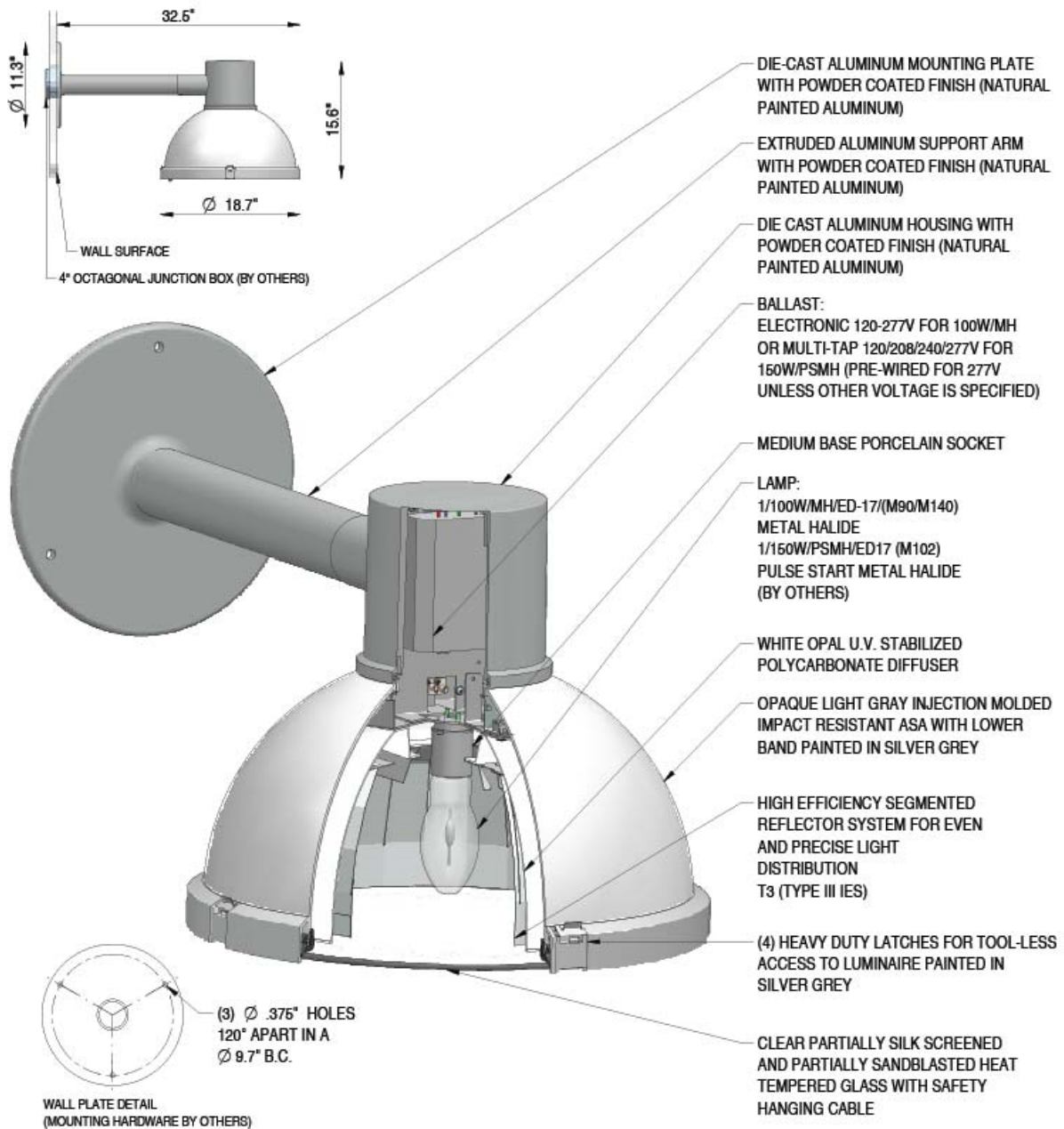

LP Icon Mini Wall

LPI-W-BASIC

PRODUCT SPECIFICATION

Light Measurements

Photometric Report: LPI-W-1-150W-MH-T5-BASIC
Report No.: ITL56872
Poulsen Report No.: LPI-W-1-150W-MH-T5-BASIC
Luminaire: LP ICON MINI WALL
Lamp: 1/150W/MH/ED17 MEDIUM
Efficiency: 75%

Description: All data shown are per 14000 lumens. This report can be used for calculation on all versions listed below. Use only actual lumen data calculating.

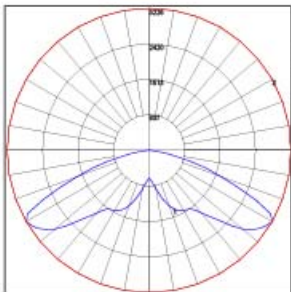

Candlepower Distribution	
Vertical Angle	Candela
0	633
5	718
15	1120
25	1488
35	1823
45	2257
55	3084
65	2875
75	1005
90	0

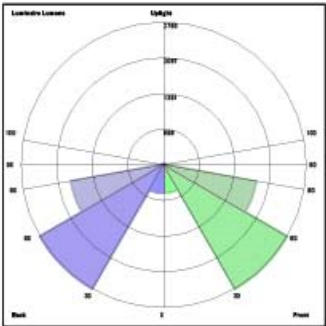

Zonal Lumen Summary

Zone	Lumens	% Lamp	% Fixture
0-20	397.15	2.80	3.80
0-30	1083.98	7.70	10.40
0-40	2128.82	15.20	20.40
0-60	6649.21	47.50	63.60
0-80	10311.19	73.70	98.70
0-90	10446.61	74.60	100.00
10-90	10372.56	74.10	99.30
20-40	1731.67	12.40	16.60
20-50	3511.75	25.10	33.60
40-70	7105.96	50.80	68.00
60-80	3661.98	26.20	35.10
70-80	1076.41	7.70	10.30
80-90	135.42	1.00	1.30
90-110	0.00	0.00	0.00
90-120	0.00	0.00	0.00
90-130	0.00	0.00	0.00
90-150	0.00	0.00	0.00
90-180	0.00	0.00	0.00
110-180	0.00	0.00	0.00
0-180	10446.61	74.60	100.00

LUMINAIRE CLASSIFICATION SYSTEM (LCS)

	Lumens	% Lamp	% Lum
FL - Front-Low (0-30)	542.0	3.9	5.2
FM - Front-Medium (30-60)	2782.6	19.9	26.6
FH - Front-High (60-80)	1831.0	13.1	17.5
FVH - Front-Very High (80-90)	67.7	0.5	0.8
BL - Back-Low (0-30)	542.0	3.9	5.2
BM - Back-Medium (30-60)	2782.6	19.9	26.6
BH - Back-High (60-80)	1831.0	13.1	17.5
BVH - Back-Very High (80-90)	67.7	0.5	0.8
UL - Uplight-Low (90-100)	0.0	0.0	0.0
UH - Uplight-High (100-180)	0.0	0.0	0.0
Total	10446.6	74.8	100.0
BUG Rating	B3-U0-G2		

LP Icon Mini Wall

LPI-W- 57W LED-OPAL

PRODUCT SPECIFICATION

Product description

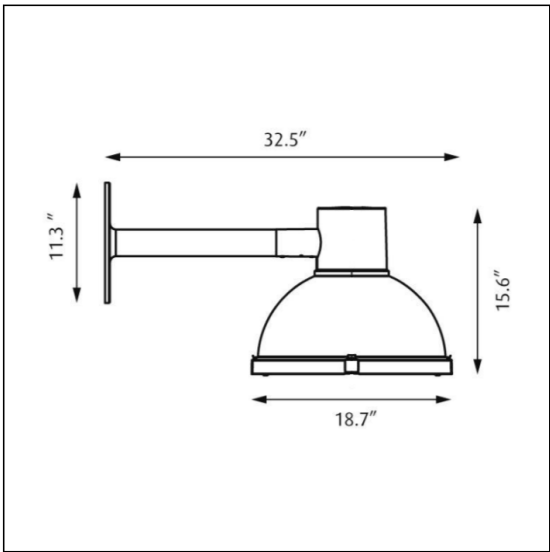

Design	Mads Odgård					
Concept	The fixture provides mainly direct downward illumination. In the opal version the shade is lit up from within and creates a soft diffuse upwards light. In the basic version the shade is opaque. Depending on the choice of reflector, the downward lighting characteristics will vary. The reflector types have been designed in two variations to provide either asymmetrical or symmetrical distributions of light.					
Finish	Natural painted aluminum, powder coated.					
Material	Enclosure: Injection molded opaque ASA (basic) or impact resistant acrylic (opal). Reflector: Pre-anodized segmented high reflectance aluminum (MH) or metallized plastic (LED). Bottom enclosure: Silk screened heat tempered glass. Housing: Die cast aluminum. Mounting plate: Cast aluminum. Arm: Extruded aluminum.					
Mounting	Surface: Mounted directly to finished surface over a recessed 4" octagonal junction box.					
Weight	Max. 35 lbs.					
Label	cULus. Wet location. IBEW.					

Product Code	Light source	Voltage	Finish	Distribution/Trim	Reflector/Optics	Shade
LPI-W	1/100W/MH/ED-17 medium	120/208/240/277V	NAT PAINT ALU	T3	MATTE	BASIC
	1/150W/MH/ED-17 medium	120-277V			POLISHED	OPAL
	57W LED/3000K					
	57W LED/4000K					

Specification notes

- a. 150W variant provided with a 120/208/240/277V ballast.
- b. 100W variant provided with a 120-277V ballast.
- c. 57W LED variant provided with a 120-277V dimmable driver (0-10V).
- d. MH variants only available with polished reflector.

LP Icon Mini Wall

LPI-W- 57W LED-OPAL

PRODUCT SPECIFICATION

Material description

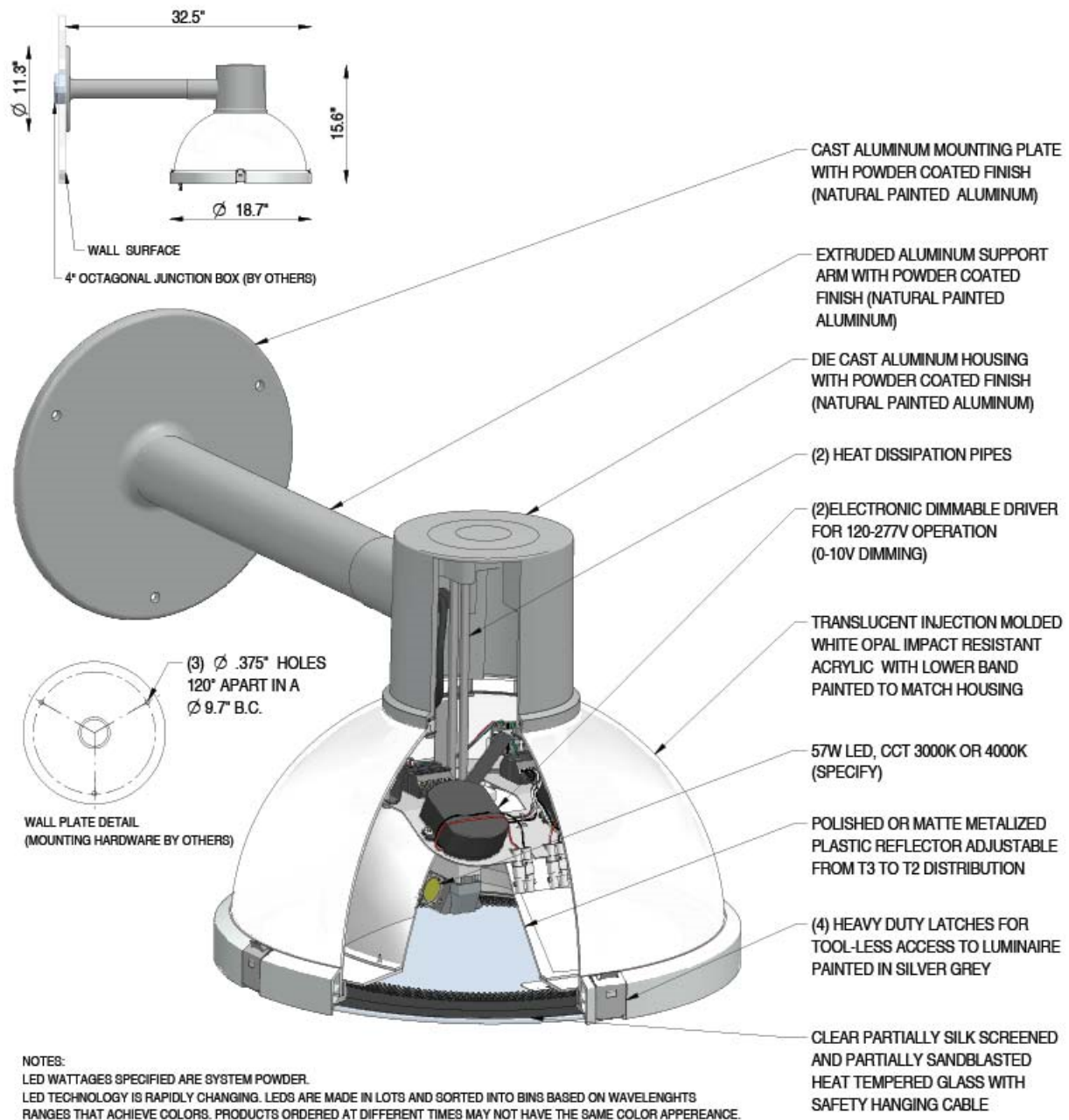

LP Icon Mini Wall

LPI-W- 57W LED-OPAL

PRODUCT SPECIFICATION

Light Measurements

Photometric Report: LPI-W-57W-LED-T3-P6-OPAL

Report No.: TL79216

Poulsen Report No.: LPI-W-57W-LED-T3-P6-OPAL

Luminaire: LP ICON MINI WALL

Lamp: 57W/LED/4000K

Description: All data shown are per 4476 lumens. This report can be used for calculation on all versions listed below. Use only actual lumen data calculating.

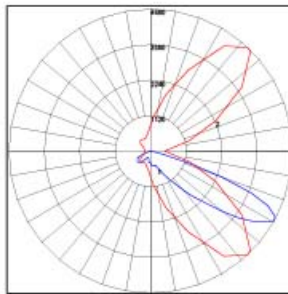

Candlepower Distribution	
Vertical Angle	Candela
0	398
5	478
15	769
25	1368
35	1994
45	2382
55	1315
65	156
75	18
90	1
120	1
150	1
180	1

Zonal Lumen Summary

Zone	Lumens	% Lamp	% Fixture
0-20	149.73	N.A.	3.30
0-30	389.51	N.A.	8.70
0-40	901.29	N.A.	20.10
0-60	3140.77	N.A.	70.20
0-80	4459.16	N.A.	99.60
0-90	4464.92	N.A.	99.70
0-90	4426.21	N.A.	98.90
20-40	751.56	N.A.	16.80
20-50	1686.02	N.A.	37.70
40-70	3347.16	N.A.	74.80
60-80	1318.39	N.A.	29.50
70-80	210.71	N.A.	4.70
80-90	5.76	N.A.	0.10
90-110	3.30	N.A.	0.10
90-120	4.92	N.A.	0.10
90-130	6.62	N.A.	0.10
90-150	9.73	N.A.	0.20
90-180	11.37	N.A.	0.30
110-180	8.07	N.A.	0.20
0-180	4476.29	N.A.	100.00

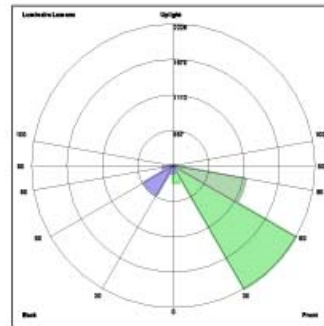

LUMINAIRE CLASSIFICATION SYSTEM (LCS)

	Lumens	% Lamp	% Lum
FL - Front-Low (0-30)	287.1	N.A.	6.0
FM - Front-Medium (30-60)	2226.2	N.A.	49.7
FH - Front-High (60-80)	1153.1	N.A.	25.8
FVH - Front-Very High (80-90)	3.7	N.A.	0.1
BL - Back-Low (0-30)	122.4	N.A.	2.7
BM - Back-Medium (30-60)	525.1	N.A.	11.7
BH - Back-High (60-80)	165.3	N.A.	3.7
BVH - Back-Very High (80-90)	2.1	N.A.	0.0
UL - Uplight-Low (90-100)	1.6	N.A.	0.0
UH - Uplight-High (100-180)	9.8	N.A.	0.2
Total	4476.4	N.A.	100.0
BUG Rating	B1-U1-G1		

LP Icon Mini Wall

LPI-W- 57W LED-BSC

PRODUCT SPECIFICATION

Product description

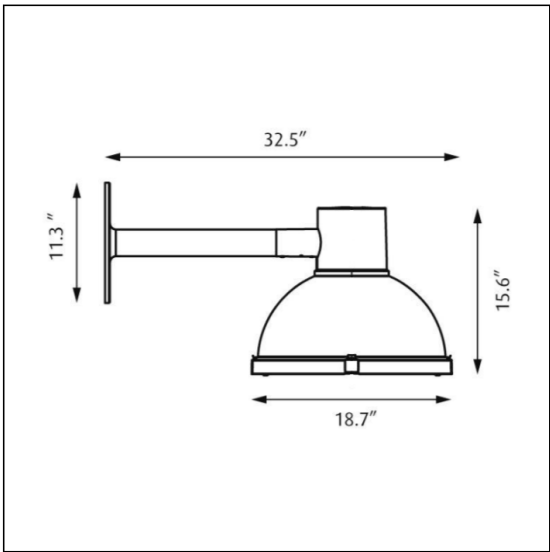

Design	Mads Odgård					
Concept	The fixture provides mainly direct downward illumination. In the opal version the shade is lit up from within and creates a soft diffuse upwards light. In the basic version the shade is opaque. Depending on the choice of reflector, the downward lighting characteristics will vary. The reflector types have been designed in two variations to provide either asymmetrical or symmetrical distributions of light.					
Finish	Natural painted aluminum, powder coated.					
Material	Enclosure: Injection molded opaque ASA (basic) or impact resistant acrylic (opal). Reflector: Pre-anodized segmented high reflectance aluminum (MH) or metallized plastic (LED). Bottom enclosure: Silk screened heat tempered glass. Housing: Die cast aluminum. Mounting plate: Cast aluminum. Arm: Extruded aluminum.					
Mounting	Surface: Mounted directly to finished surface over a recessed 4" octagonal junction box.					
Weight	Max. 35 lbs.					
Label	cULus. Wet location. IBEW.					

Product Code	Light source	Voltage	Finish	Distribution/Trim	Reflector/Optics	Shade
LPI-W	1/100W/MH/ED-17 medium	120/208/240/277V	NAT PAINT ALU	T3	MATTE	BASIC
	1/150W/MH/ED-17 medium	120-277V			POLISHED	OPAL
	57W LED/3000K					
	57W LED/4000K					

Specification notes

- a. 150W variant provided with a 120/208/240/277V ballast.
- b. 100W variant provided with a 120-277V ballast.
- c. 57W LED variant provided with a 120-277V dimmable driver (0-10V).
- d. MH variants only available with polished reflector.

LP Icon Mini Wall

LPI-W- 57W LED-BSC

PRODUCT SPECIFICATION

Material description

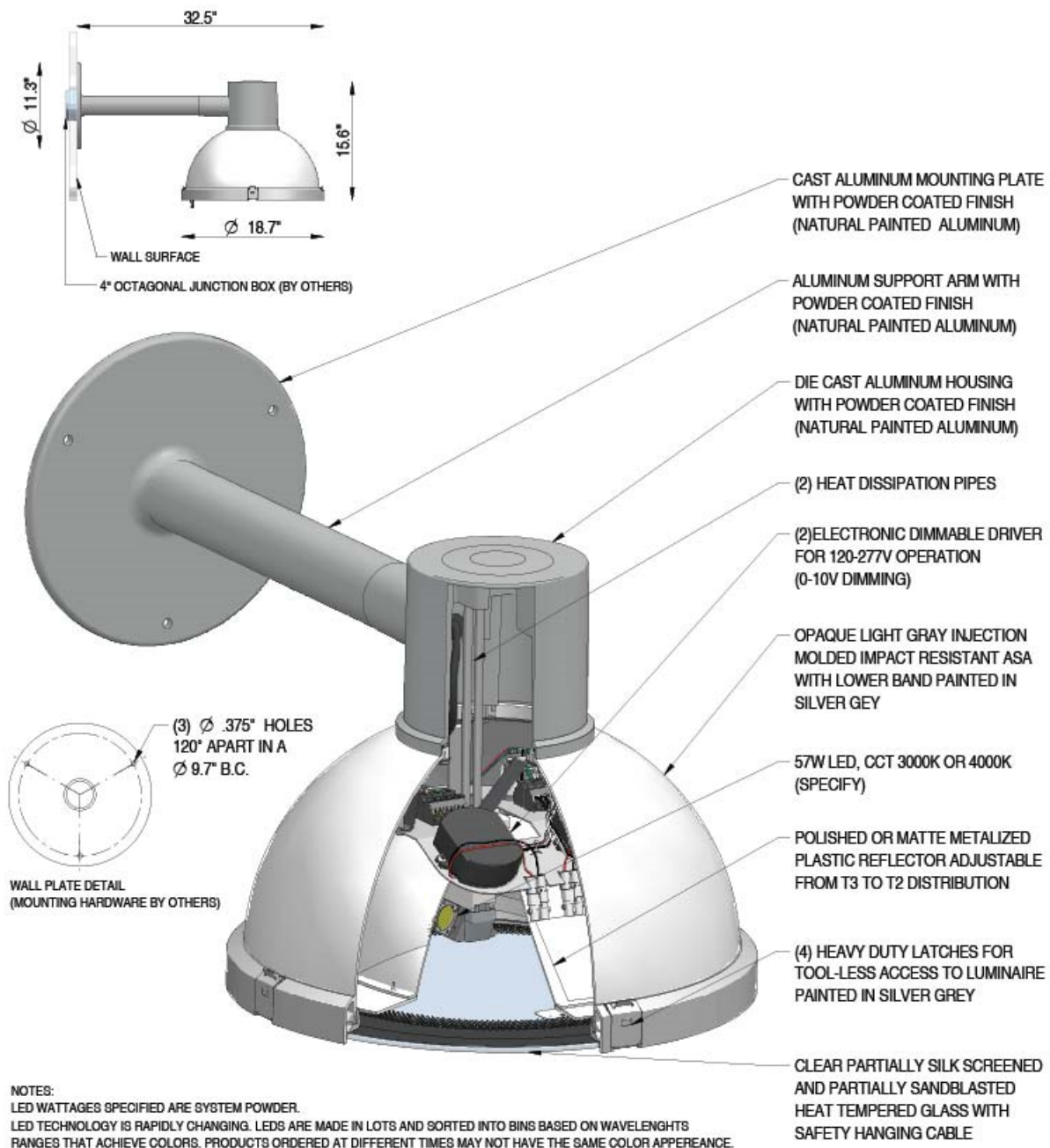

LP Icon Mini Wall

LPI-W- 57W LED-BSC

PRODUCT SPECIFICATION

Light Measurements

Photometric Report: LPI-W-57W-LED-T3-P6-BASIC

Report No.: ITL81198

Poulsen Report No.: LPI-W-57W-LED-T3-P6-BASIC

Luminaire: LP ICON MINI WALL

Lamp: 57W/LED/4000K

Description: All data shown are per 4515 lumens. This report can be used for calculation on all versions listed below. Use only actual lumen data calculating.

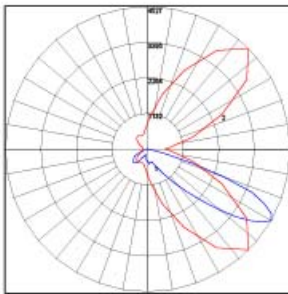

Candlepower Distribution	
Vertical Angle	Candela
0	373
5	428
15	676
25	915
35	1427
45	2088
55	1231
65	165
75	12
90	0

Zonal Lumen Summary

Zone	Lumens	% Lamp	% Fixture
0-20	139.36	N.A.	3.10
0-30	368.43	N.A.	8.20
0-40	667.87	N.A.	19.20
0-60	3141.32	N.A.	69.60
0-80	4511.96	N.A.	99.90
0-90	4514.62	N.A.	100.00
10-90	4477.68	N.A.	99.20
20-90	728.51	N.A.	16.10
20-50	1661.94	N.A.	36.80
40-70	3413.56	N.A.	75.60
60-80	1370.64	N.A.	30.40
70-80	230.53	N.A.	5.10
80-90	2.66	N.A.	0.10
90-110	0.00	N.A.	0.00
90-120	0.00	N.A.	0.00
90-130	0.00	N.A.	0.00
90-150	0.00	N.A.	0.00
90-180	0.00	N.A.	0.00
110-180	0.00	N.A.	0.00
0-180	4514.62	N.A.	100.00

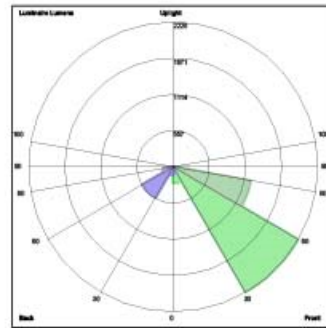

LUMINAIRE CLASSIFICATION SYSTEM (LCS)

	Lumens	% Lamp	% Lum
FL - Front-Low (0-30)	246.9	N.A.	5.5
FM - Front-Medium (30-60)	2228.1	N.A.	49.4
FH - Front-High (60-90)	1211.3	N.A.	26.8
FVH - Front-Very High (90-180)	1.7	N.A.	0.0
BL - Back-Low (0-30)	121.5	N.A.	2.7
BM - Back-Medium (30-60)	544.8	N.A.	12.1
BH - Back-High (60-90)	159.3	N.A.	3.5
BVH - Back-Very High (90-180)	0.0	N.A.	0.0
UL - Uplight-Low (90-180)	0.0	N.A.	0.0
UH - Uplight-High (180-360)	0.0	N.A.	0.0
Total	4514.6	N.A.	100.0
BUG Rating	B1-U0-G1		